

APV D4 / D4 SL

双座防混阀

文件编号: H338792

版本: CN-2

在操作或维护本产品之前, 请阅读并理解本说明书。



欧盟关于阀门和阀阵的符合性声明

SPX Flow Technology Germany GmbH
Gottlieb-Daimler-Str. 13, D-59439 Holzwickede
特此声明

SD4、SDT4、SDU4、SDMS4、SDMSU4、SDTMS4、SWcip4、DSV、DA4、D4 SL、D4、DA3、DA3SLD、DE3、DEU3、DET3、DKR2、DKRT2、DKRH2系列APV双密封阀和双座阀
公称直径DN 25 - 150、ISO 1" - 6" 和1 Sh5 - 6 Sh5

SV1和SVS1F、SV2和SV2F、SVL和SVSL系列APV蝶阀
公称直径DN 25 - 100、DN 125 - 250和ISO 1" - 4"

KHI、KHV、BLV1系列APV球阀
公称直径DN 15 - 100、ISO 1/2"-4"

S2、SW4、SWhp4、SW4DPF、SWmini4、SWT4、SWS4、MF4、MS4、MSP4、AP/T1、CPV、RG4、RG4DPF、RGMS4、RGE4、RGE4DPF、RGEMS4、PR2、PRD2、SI2、UF/R3、VRA/H系列APV单座阀、弹簧式隔膜阀
公称直径DN 10 - 150、ISO 1/2" - 4" 和1 Sh5 - 6 Sh5

以及由上述阀门制成的阀阵

符合指令2006/42/EC（替代89/392/EEC或98/37/EC）以及ProdSG（替代GPSG - 9.GPSGV）的要求。

SPX FLOW依照机械指令附录VII，提供相应的监管控制技术文件，包括设计和结构文件，其中说明了为确保遵守并符合基本健康和国家安全要求（包括风险分析）所应采取的措施，包括风险分析，以及包含安全说明的使用说明书。

特此保证阀门和阀阵的合规性。

文件授权代表：
Frank Baumbach

SPX Flow Technology Germany GmbH
Gottlieb-Daimler-Str. 13, D-59439 Holzwickede, 德国

2020年1月

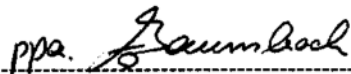

Frank Baumbach
Engineering Director – Sanitary Components

目录		页码
1.	概述	6
2.	安全	6
2.1.	符号标志	
2.2.	安全提示	
3.	预期用途	7
4.	作用方式	8
4.1.	概述	
4.2.	阀门处于“关闭”位置	
4.3.	阀门处于“打开”位置	
5.	控制单元 / 阀门位置反馈	10
5.1.	控制单元和转接器	
5.2.	阀门位置反馈	
6.	清洗	11
6.1.	流动室	
6.2.	D4 SL 阀门：阀座区	
6.3.	阀座区和泄漏腔	
6.4.	清洗建议	
6.5.	D4 SL 阀门：清洗上部区域	
6.6.	D4 SL 阀门：清洗下部区域	
7.	安装和调试	13
7.1.	焊接提示	
8.	尺寸 / 重量	14
8.1.	D4 阀门	
8.2.	D4 SL 阀门	
9.	技术数据	16
9.1.	一般数据	
9.2.	压缩空气质量	
9.3.	Kvs 值，单位	
9.4.	空气消耗量 / 开关时间	
9.5.	阀门行程 / 开口横截面	
10.	维护	19
11.	拆卸 / 安装说明	20
11.1.	从管道系统上拆卸	
11.2.	拆卸与产品接触的部件	
11.3.	安装与产品接触的密封并组装阀门	
11.4.	安装阀芯	
12.	驱动器的维护	24
12.1.	拆卸驱动螺杆	
12.2.	安装密封和组装驱动器	
13.	密封装配说明和安装工具	25
13.1.	下阀杆密封	
13.2.	中间密封	
13.3.	阀座密封	
14.	故障排除	28
15.	备件清单	28
	D4 1.5"-4", DN40-100	RN 500.047.01
	D4 6", DN125-150	RN 500.047.03
	D4 SL 1.5"-4", DN40-100	RN 501.047.01
	D4 SL 6", DN125-150	RN 501.047.03

1. 概述

有关操作人员和维护人员必须阅读并遵守本操作说明书。

特此声明，对于因为未遵守操作说明而导致的损坏和故障，我们概不承担任何责任。

我们保留对图示和数据信息进行技术更改的权利。

2. 安全

2.1. 符号标志



注意！

职业安全标志提醒您注意与职业安全相关的重要提示信息。在所述操作可能对您的健康和 / 或财产带来相应危险的地点都可以看到职业安全标志。



重要提示！

重要技术信息

2.2. 安全提示



严禁打开驱动器和上阀杆。存在危害健康和生命的危险！

必须按规定妥善处理不再使用和 / 或无效的驱动器和上阀杆。

必须将损坏的驱动器和上阀杆送回您的 SPX FLOW 销售公司，销售公司可以免费为您进行专业的废弃处理。

请联系您的 SPX FLOW 销售公司。



- 切勿在处理炙热液体或消毒过程中接触阀门或管道！



- 维护之前应断开电气和气动连接。



- 在进行维护工作之前，管路和清洁系统必须卸压，如有可能，进行排空！

2. 安全



- 为确保安全维护阀门，请按照安装说明进行操作。
- 未使用的接口必须用堵塞封闭！
- 必须确保安全排放相应的冲洗介质！
- 只能由经过阀门培训的人员或 SPX FLOW 安装人员对阀门进行组装、拆卸和重新安装。如有必要，请联系您当地的 SPX FLOW 办事处。

3. 预期用途

双座阀应用范围的预期用途是在食品和饮料工业以及制药和化学应用中安全关闭管段以及分离不相容的介质。



注意！标准 D4 / D4 SL 阀门不得用于潜在的爆炸性环境中。

注意！请勿擅自改动阀门，否则会影响阀门的安全性和预期功能。

SPX FLOW 阀门专为应用于食品和饮料、制药及化学工业而设计

根据压力设备指令 2014/68/EU 的规定，SPX FLOW 阀门（不含安全功能）属于 1 类设备，并根据符合性评定程序归为模式 A。

根据第 13 条的规定，在阀门中处理的流体适用以下分配：

产品介质 - 流体组 2 - 所有公称尺寸的阀门。

CIP 清洁介质 - 流体组 1 - 公称尺寸 ≤ DN100/4" 的阀门可在最高 140 °C 的温度下使用，公称尺寸 > DN100/4" 的阀门可在 100 °C 的温度下使用。

认证和外部评估

如要查看此产品和其它 SPX FLOW 创新产品的认证证书，请访问：
<https://www.spxflow.com/en/apv/about-us/certifications/>

设备运营商有责任评估并验证 SPX FLOW 产品在预期用途和维修条件下的适用性，确定并遵守适用于预期用途和应用领域的法律。

4. 作用方式

图 4.1 D4 阀门

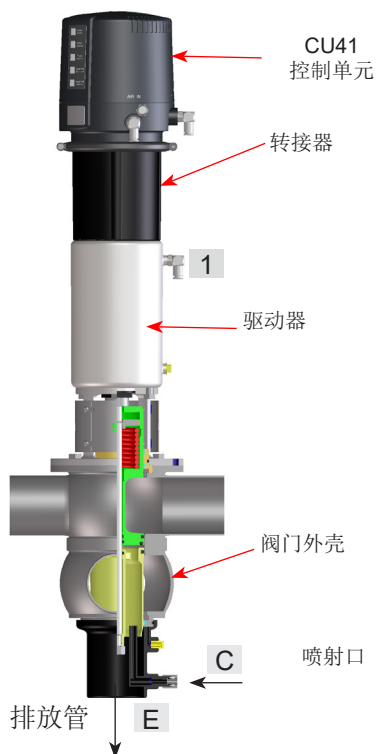

4.1. 概述

APV DA4 双座阀因其结构和作用方式以及使用了高品质不锈钢和相应的密封材料，因此非常适合用于食品、饮料、制药和化工行业领域。

- D4 和 D4 SL 阀门通过两个平衡并可独立作用的阀杆，以中间泄漏腔的形式将两个管段分隔开来。
- 阀门自上而下以低泄漏方式打开。
- 泄漏通过泄漏管到 (E) 排出，没有压力。
- 气动驱动器通过空气接口 (1) 打开阀门。在弹簧力作用下，阀门移动到“关闭”安全终点位置。
- 标准 D4 阀门配备有一个无通风功能的驱动器和一个 CU41 控制单元。
- 标准 D4 SL 阀门配备有一个具有通风功能的驱动器和一个 CU43 控制单元。
- **D4 SL 阀门：**
阀座区的清洁通过操作空气接口完成：
2 = 上阀杆通风
3 = 下阀杆通风
- 通过冲洗接口 (C) 对泄漏腔进行清洁。
- 或者也可以通过接近开关检测 D4 和 D4 SL 阀门的关闭和打开位置。

图 4.1.1 D4 SL 阀门



图 4.1.2.



4. 作用方式

图 4.2.

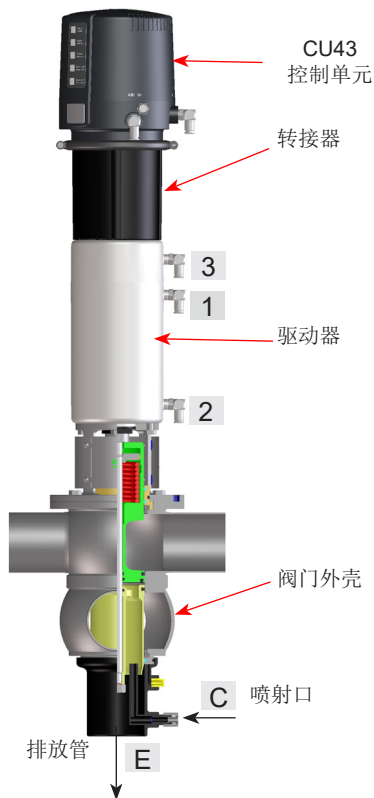
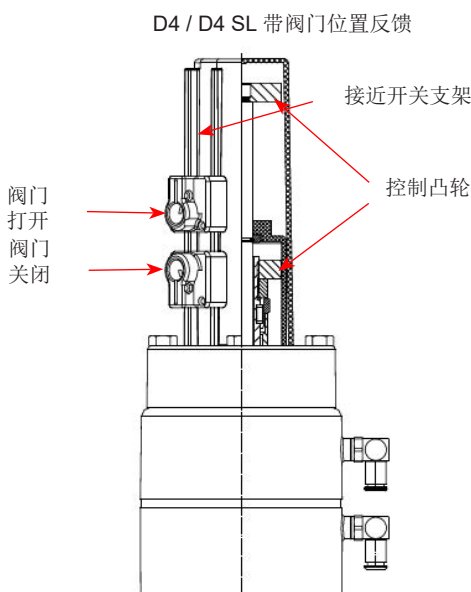
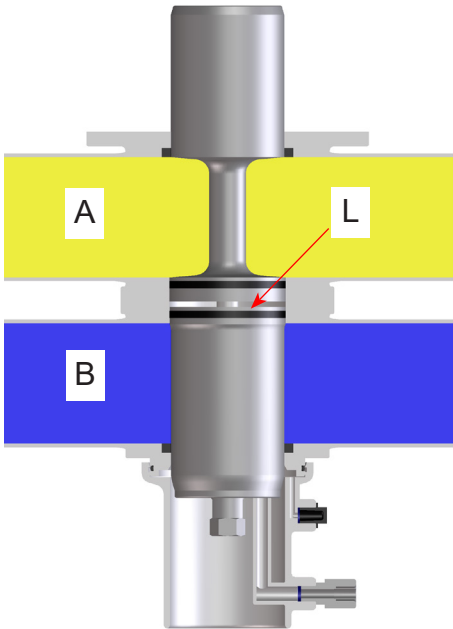

- 4.2.** 阀门处于“关闭”位置
下阀杆和上阀杆处于关闭位置，并且将不同的介质 A 和 B 彼此安全分隔。两个阀杆之间是泄漏腔 L，它可确保液体自由向下流动，并且绝对没有压力。阀杆保持平衡，因此可以承受住压力。

图 4.3.

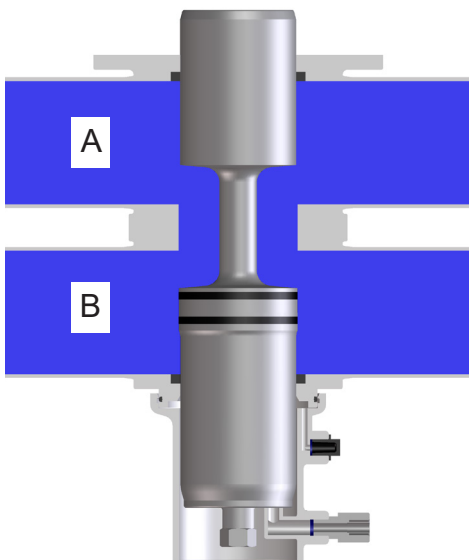

- 4.3.** 阀门处于“打开”位置
启动驱动器后，上阀杆将压向下阀杆的密封件。
首先关闭通向产品腔的泄漏腔 L 部分。
之后，两个阀杆向下移动到打开位置。管道 A 和 B 之间形成连接。

5. 控制单元 / 阀门位置反馈

- 5.1. 控制单元和转接器**
需要一个转接器才能将控制单元安装在 DA4 阀上。有以下规格可供使用：

名称	D4		D4 SL	
∅ 空气接口直径	6 mm	1/4" 外径	6 mm	1/4" 外径
CU4 控制单元				
直接连接	CU41-D4 直接连接 H336954	CU41-D4 直接连接 H336959	CU43-D4 直接连接 H336955	CU43-D4 直接连接 H336960
直接连接 M12	CU41-D4-M12 直接连接 M12 H341342	CU41-D4-M12 直接连接 M12 H341351	CU43-D4-M12 直接连接 M12 H341343	CU43-D4-M12 直接连接 M12 H341352
AS-interface 扩展接口	CU41-D4 AS-i 扩展接口 H336956	CU41-D4 AS-i 扩展接口 H336961	CU43-D4 AS-i 扩展接口 H336957	CU43-D4 AS-i 扩展接口 H336962
AS-interface 扩展接 口 M12	CU41-D4-M12 AS-i 扩展接口 M12 H338878	CU41-D4-M12 AS-i 扩展接口 M12 H338900	CU43-D4-M12 AS-i 扩展接口 M12 H338897	CU43-D4-M12 AS-i 扩展接口 M12 H338901
AS-interface 标准接 口	CU41-D4 AS-i 标准接口 H338150	CU41-D4 AS-i 标准接口 H338151	CU43-D4 AS-i 标准接口 H338152	CU43-D4 AS-i 标准接口 H338153
AS-interface 标准接口 M12	CU41-D4-M12 AS-i 标准接口 M12 H338898	CU41-D4-M12 AS-i 标准接口 M12 H338902	CU43-D4-M12 AS-i 标准接口 M12 H338899	CU43-D4-M12 AS-i 标准接口 M12 H338903
转接器	CU4 转接器 D4 H337098			
CU4plus 控制单元				
AS-interface 扩展接口 V1	CU41plus-D4-V1 AS-i 扩展接口 V1 H338819	CU41plus-D4-V1 AS-i 扩展接口 V1 H338823	CU43plus-D4-V1 AS-i 扩展接口 V1 H338820	CU43plus-D4-V1 AS-i 扩展接口 V1 H338824
AS-interface 扩展接 口 V1 M12	CU41plus-D4-V1-M12 AS-i 扩展接口 V1 M12 H338864	CU41plus-D4-V1-M12 AS-i 扩展接口 V1 M12 H338868	CU43plus-D4-V1-M12 AS-i 扩展接口 V1 M12 H338865	CU43plus-D4-V1-M12 AS-i 扩展接口 V1 M12 H338869
转接器	CU4plus 转接器 D4 V1 H336441			

- 5.2. 阀门位置反馈**
用于指示阀杆终端位置的接近开关，可以安装在接近开关支架上。

建议使用以下其中一种标准类型：

三线制接近开关
切换距离：5 mm
直径：11 mm
工作电压：10–30 V DC
pnp 正开关，常开功能
“非平贴式”安装

建议

接近开关 24V DC，PNP，11 mm 直径（5 m 电缆）：H16223
接近开关 24V DC，PNP，11 mm 直径（电缆盒）：H16432

如果客户使用不同的阀门位置反馈器，则无法保证无故障功能。

6. 清洗

清洗阀门时，应区分以下区域：流动室、阀座区和泄漏腔。

6.1. 流动室

在 CIP 清洗过程中，CIP 液体会清洗上通道和下通道。

6.2. D4 SL 阀门：阀座区（章节 6.5. 和 6.6.）

在清洗各个通道期间，通过对各阀杆进行通风来清洁阀座区和泄漏腔。

6.3. 阀座区和泄漏腔

阀座区和泄漏腔通过 CIP 喷射进行清洗。CIP 清洗连接口 C 如图 6.3 所示。

图 6.3.

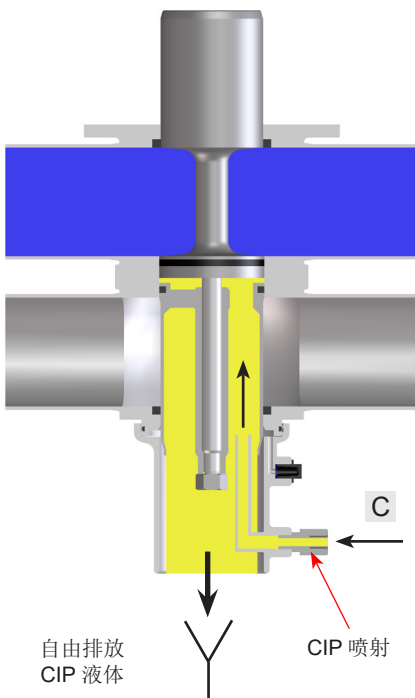

D4 阀门：必须始终执行 CIP 喷射。

CIP 喷射不会在泄漏腔中产生任何压力积聚。SPX FLOW 建议，在阀门关闭位置时进行 CIP 喷射。但是，也可以在阀门打开情况下完成。

在通常情况下，通过 DN 25 喷射歧管可以清洗 15 个 DN 40-100 / 1.5"-4" 阀门、10 个 DN 125-150 / 6" 阀门。

6.4. 清洗建议

清洗步骤	通风周期 (D4 SL)	CIP 喷射
预冲洗	—	3 x 10 秒
80 °C 碱液	3 x 5 秒	3 x 10 秒
中间冲洗	2 x 5 秒	2 x 10 秒
酸液	3 x 5 秒	3 x 10 秒
后冲洗	2 x 5 秒	2 x 10 秒

- **D4 SL 阀门：** 通风时间基于 $p = 2 - 5 \text{ bar}$ 的清洁压力。
- 根据压力条件、清洗温度、清洗步骤和污染程度，必须设定其他时间。
- 每次 CIP 喷射的清洗量：
 DN 40-100/1.5-4" 大约 1.2 升 /10 秒
 DN125-150/6" 大约 5.0 升 /10 秒
- CIP 清洗连接口的清洗压力： 最低 2 bar
 最高 5 bar



注意！

所使用的清洗介质必须与各密封材料兼容。

6. 清洗

图 6.5.

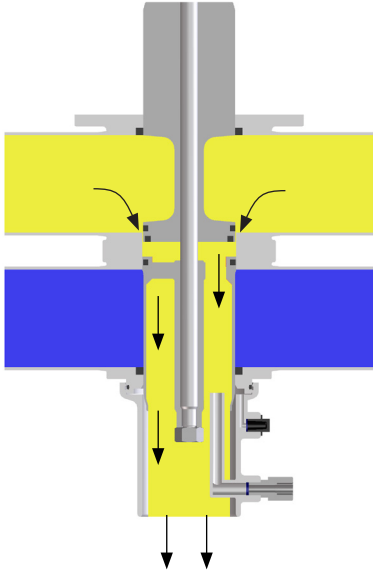

6.5. D4 SL 阀门：清洗上部区域（图 6.5.）

上阀杆通过接口 (2) 通风，如第 8 页的图 4.1.1 所示。

通过上阀杆通风，清洁剂通过上阀座密封件和上阀盘流入泄漏腔，清洁该区域。清洁剂在没有压力的情况下排放到底部。

通风行程由金属挡块加以限制。

图 6.6.

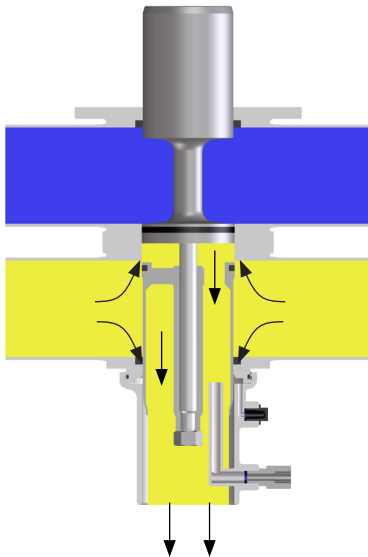

6.6. D4 SL 阀门：清洗下部区域（图 6.6.）

下阀杆通过接口 (3) 通风，如第 8 页上的图 4.1.1 所示。

通过下阀杆通风，清洁剂通过下阀座密封件流入泄漏腔，清洁该区域。清洁剂在没有压力的情况下排放到底部。

通风行程由金属挡块加以限制。

7. 安装和调试



- 必须以竖直位置完成安装。液体必须能自由流出阀门外壳和泄漏腔。
注意！ 必须安全收集并排出因通风过程和 CIP 喷射所导致的泄漏和液体损失。



- 阀门外壳可以直接焊接到管道上（完全可拆卸式阀芯）
提示！ 遵守焊接提示。



- 应注意安装和拆卸高度！
注意！
首次投入运行之前：
- 使用压缩空气操作阀门。打开过程、关闭过程和阀座通风过程必须能够顺利无障碍地进行。
- 检查控制单元的功能或阀门位置反馈。
- 在调试期间注意可能的泄漏。更换损坏的密封件。

7.1. 焊接提示



- 在焊接阀门之前，必须将阀芯从阀门外壳中取出。
注意！ 小心处理阀芯并妥善存放，以避免损坏。



DN40-100/1.5-4"： 将下阀杆密封和导向环从外壳中拆卸出来。

DN125-150/6"： 下阀杆密封必须留在阀体中，因为在拆卸时可能会被损坏。

- 必须由经过认证的焊工（DIN EN ISO 9606-1）执行所有焊接工作（焊缝质量 DIN EN ISO 5817）。
- 在焊接阀门外壳时，必须确保无法从外部将张力传输到阀体中。
- 壁厚不超过 3 mm 的焊缝应钝化处理为无空气接头。注意热缩尺寸！
- 建议使用 TIG 轨道焊接技术！



注意！ 注意！ 阀门外壳或对接法兰焊接后或在管道作业之后，必须在切换阀门之前清除相应系统部件或管道上的焊接残留物和污垢。若在操作之前未清洁管道，则可能会导致焊渣或碎屑滞留在阀门中，并会损坏阀门和密封件。

- 因不遵守焊接提示而造成的任何损坏，均不在我们的保修范围内。
- 适用 AWS/ANSI 和 EHEDG 指令中的相关无菌区域焊接指导原则。

8. 尺寸 / 重量

8.1. D4 阀门

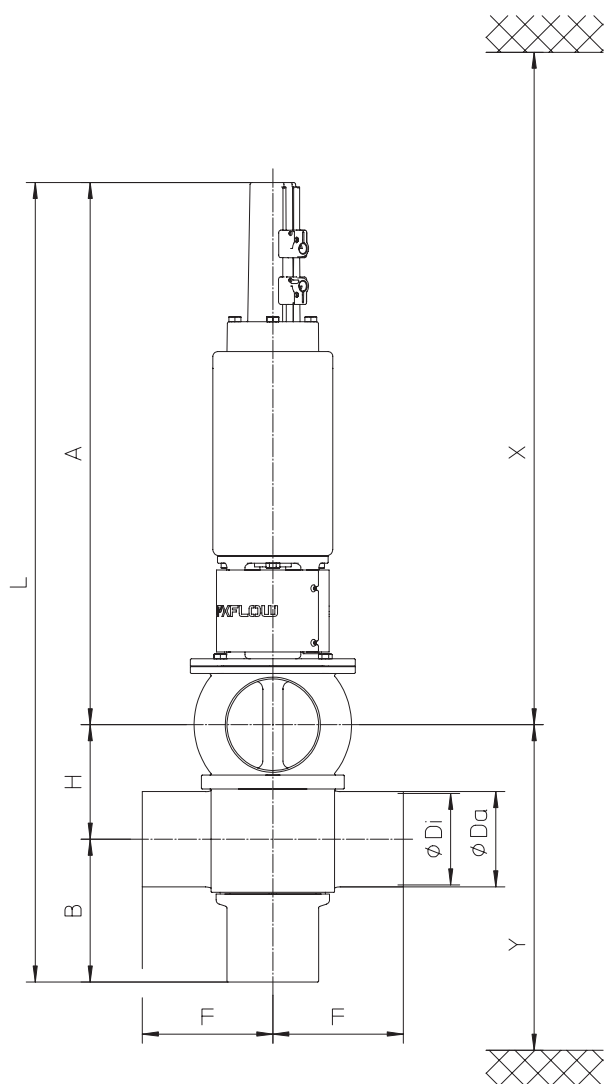

CU4 控制单元

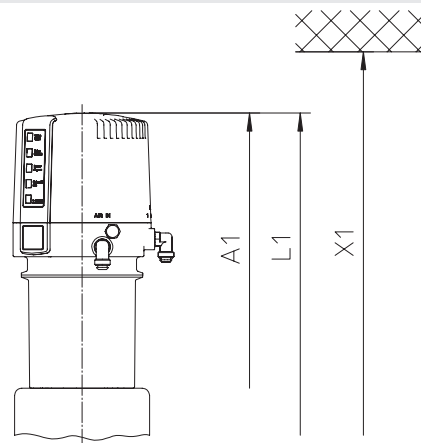

阀门外壳配置

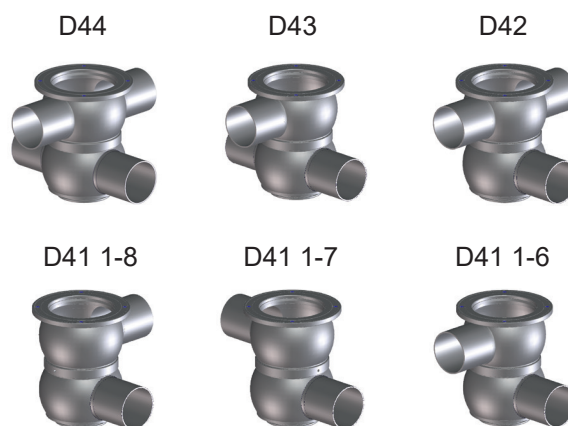

尺寸, 单位: mm										安装尺寸 最小, 单位: mm			重量, 单位: kg 含控制单元
DN	A	A1	B	Ø 外径	Ø 内径	F	H	L	L1	X*	X1*	Y*	
40	483	566	120	41	38	125	63	666	749	710	790	200	14.9
50	487	570	126	53	50	125	75	688	771	740	820	218	15.0
65	495	578	134	70	66	125	91	720	803	780	860	242	16.6
80	583	666	146	85	81	142.5	106	835	918	890	980	274	25.5
100	593	676	156	104	100	142.5	125	874	957	940	1020	303	25.9
125	677	760	179	129	125	150	150	1006	1089	1030	1115	350	41.0
150	725	793	194	154	150	150	175	1094	1162	1075	1160	390	49.0
英寸													
1.5"	483	566	119	38.1	34.8	125	63	667	750	710	790	199	14.9
2"	487	570	125	50.8	47.6	125	75	688	771	740	820	217	15.0
2.5"	495	578	131	63.5	60.3	125	85.3	708.3	791.3	760	840	234	15.7
3"	583	666	137	76.1	72.9	125	97.9	732.9	815.9	790	880	252	16.1
4"	593	676	155	101.6	97.6	142.5	125	874	957	940	1030	302	25.3
6"	727	794	193	152.4	146.9	150	175	1095	1162	1080	1165	390	49.0

* 最小安装和拆卸尺寸

8. 尺寸 / 重量

8.2. D4 SL 阀门

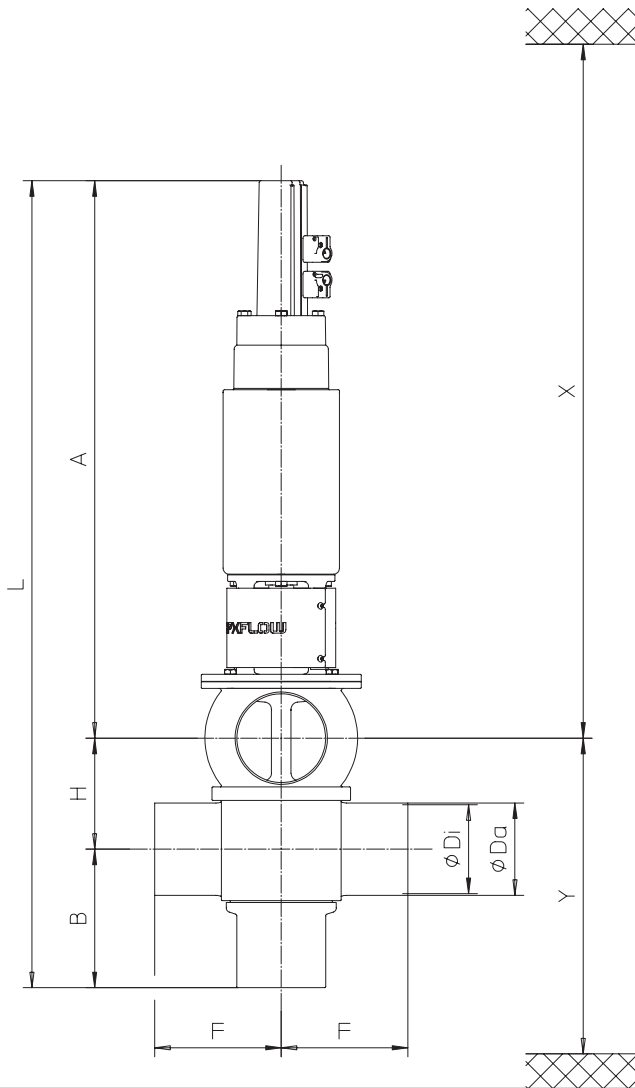

CU4 控制单元

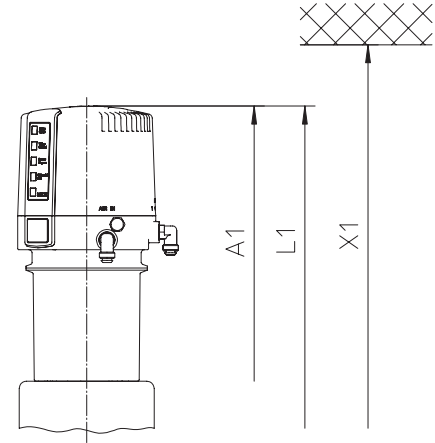

阀门外壳配置

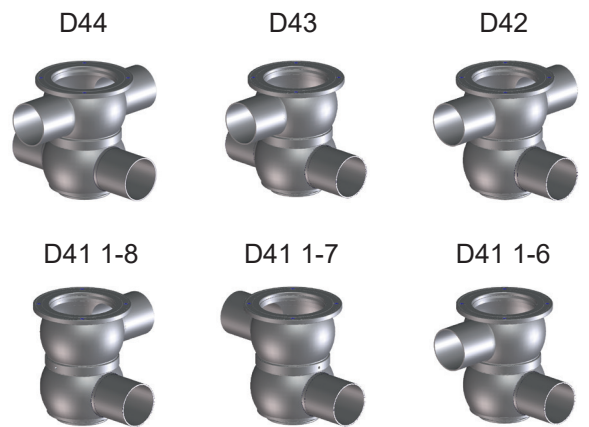

尺寸, 单位: mm										安装尺寸 最小, 单位: mm			重量, 单位: kg 含控制单元
DN	A	A1	B	Ø 外径	Ø 内径	F	H	L	L1	X*	X1*	Y*	
40	524	607	120	41	38	125	63	707	790	750	830	200	15.5
50	528	611	126	53	50	125	75	729	812	780	860	218	15.6
65	536	619	134	70	66	125	91	761	844	820	900	242	17.2
80	618	701	146	85	81	142.5	106	870	953	925	1010	274	25.5
100	628	711	156	104	100	142.5	125	909	992	980	1060	303	25.9
125	677	760	179	129	125	150	150	1006	1089	1030	1115	350	41.0
150	725	793	194	154	150	150	175	1094	1162	1075	1160	390	53.5
英寸													
1.5"	526	609	119	38.1	34.8	125	63	708	791	750	840	199	15.5
2"	529	612	125	50.8	47.6	125	75	729	812	780	860	217	15.6
2.5"	534	617	131	63.5	60.3	125	85.3	750.3	833.3	800	890	234	16.3
3"	540	623	137	76.1	72.9	125	97.9	774.9	857.9	830	920	252	16.7
4"	629	712	155	101.6	97.6	142.5	125	909	992	980	1060	302	25.9
6"	727	794	193	152.4	146.9	150	175	1095	1162	1080	1165	390	53.5

* 最小安装和拆卸尺寸

9. 技术数据

9.1. 一般数据		
与产品接触的部分		1.4404, 316L (DIN EN 10088)
其他部分		1.4301, 304 (DIN EN 10088)
密封件		
DN40–100/1.5"-4" 标准		EPDM
DN40–100/1.5"-4" 选项		HNBR, FPM
DN125-150, 6" 标准		EPDM/PTFE 合成材料
DN125-150, 6" 选项		HNBR/PTFE 合成材料 FPM/PTFE 合成材料
最大管路压力		10 bar
最高工作温度		135 °C EPDM、HNBR FPM*
短时负载		140 °C EPDM、HNBR FPM* * 无蒸气
阀门 > DN100/4"		CIP 清洁介质至 100 °C
止动螺钉拧紧扭矩		10 Nm
下阀杆和上阀杆锁紧螺母拧紧扭矩		40 Nm
清洗接口		PP (聚丙烯)
Ø 清洗接口直径		
DN40–100/1.5"-4"		8 x 1 mm
DN125-150/6"		10 x 1 mm
Ø 空气接口直径		6 x 1 mm, 1/4" 外径
最大控制空气压力		8 bar
最小控制空气压力		5 bar
9.2. 压缩空气质量		
质量等级		符合 DIN ISO 8573-1
固体颗粒含量 :		质量等级 3, 每立方米 (m ³) 最大颗粒尺寸 10000 个 0.5 µm < 直径 < 1.0 µm 500 个 1.0 µm < 直径 < 5.0 µm
含水量 :		质量等级 3, 最高露点温度 -20 °C 对于低温条件或高海拔地区的安装, 必须采取其它措施来相应降低压力露点。
含油量 :		质量等级 1, 最大 0.01 mg/m ³
所使用的油品必须与聚氨酯弹性体材料相容。		

9. 技术数据

9.3. Kvs 值, 单位: m³/h

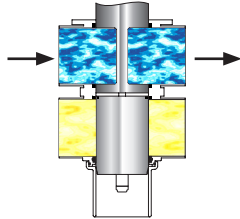
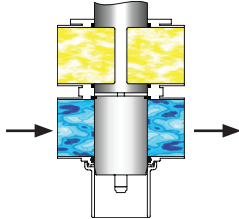
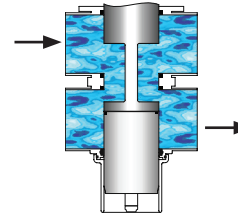
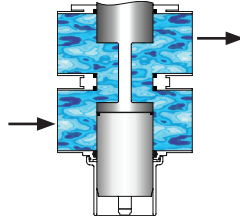
DN								
	D4	D4 SL	D4	D4 SL	D4	D4 SL	D4	D4 SL
40	49	48	44	44	33	24	33	24
50	94	91	75	75	53	48	52	46
65	170	184	150	150	83	74	80	74
80	211	210	170	170	135	131	132	126
100	369	370	246	246	174	170	155	156
125	588	588	380	380	270	270	258	258
150	844	844	567	567	393	393	371	371
英寸								
1.5"	43	42	38	38	31	24	30	23
2"	87	83	71	71	51	46	51	46
2.5"	156	147	122	122	74	67	72	67
3"	192	183	160	160	88	83	85	82
4"	359	367	237	237	170	167	152	156
6"	808	808	548	548	386	386	370	370

9.4. 空气消耗量 / 开关时间

D4 阀门		5 bar 时的空气消耗量 驱动器	开关时间, 单位: 秒 (5 bar / CU41)	
DN	英寸	标准升 / 行程 阀门打开	打开	关闭
40	1.5"	1.6	1.0	1.4
50	2"	1.8	1.1	1.7
65	2.5"	2	1.7	2.0
	3"	2	1.7	2.0
80	4"	3.7	2.6	3.3
100		3.7	2.6	3.3
125		5.5	3.4	5.2
150	6"	8.6	3.5	9.3

D4 SL 阀门		5 bar 时的空气消耗量			开关时间, 单位: 秒 5 bar / CU43 时	
DN	英寸	驱动器	通风缸		打开	关闭
		标准升 / 行程 阀门打开	标准升 / 行程 上部通风	标准升 / 行程 下部通风		
40	1.5"	1.5	3.4	0.22	1.5	1.7
50	2"	1.7	3.4	0.22	1.5	1.7
65	2.5"	1.8	3.4	0.22	1.6	1.9
	3"	2	3.4	0.22	1.7	2.0
80	4"	3.7	7.7	0.22	2.6	3.3
100		3.7	7.7	0.22	2.6	3.3
125		5.5	10.5	0.22	3.4	5.2
150	6"	8.6	16.5	0.74	3.5	9.3

9. 技术数据

9.5. 阀门行程 / 开口横截面

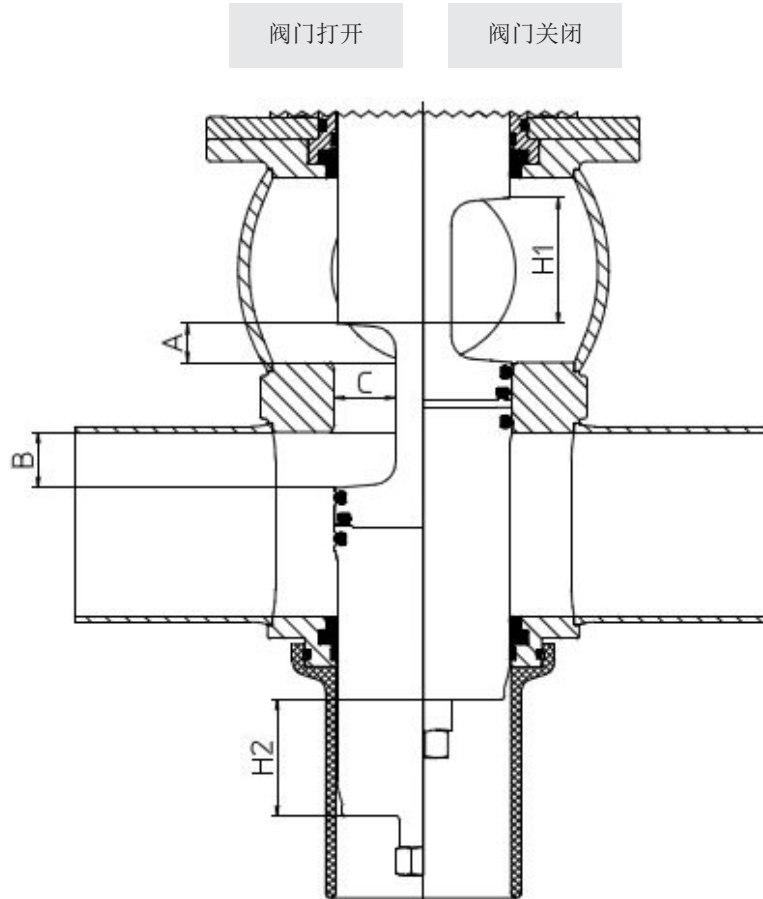

D4 阀门：尺寸，单位：mm					
DN	A	B	C	行程 H1 上阀杆	行程 H2 下阀杆
40	6	7	22	32	29
50	13	12	22	37	34
65	21	20	22	45	42
80	30	25	36	50	47
100	49	25	36	50	47
125	58	35	43	60	57
150	78	40	53	65	62
英寸					
1.5"	6	7	22	32	29
2"	13	12	22	37	34
2.5"	15.3	20	22	45	42
3"	27.9	20	22	45	42
4"	49	25	36	50	47
6"	78	40	53	65	62

D4 SL 阀门：尺寸，单位：mm					
DN	A	B	C	行程 H1 上阀杆	行程 H2 下阀杆
40	4	4	22	29	26
50	9	9	22	34	31
65	13	12	22	45	42
80	24	25	36	50	47
100	43	25	36	50	47
125	58	35	43	60	57
150	78	40	53	65	62
英寸					
1.5"	4	4	22	29	26
2"	9	9	22	34	31
2.5"	14.3	14	22	39	36
3"	20.9	20	22	45	42
4"	43	25	36	50	47
6"	78	40	53	65	62

10. 维护



提示！

维护周期取决于不同的应用，应由用户通过定期检查自行确定。

- 拆卸阀门时不需要压缩空气。



注意！

不得使用含有研磨剂或抛光剂的产品清洁阀门。含有研磨剂和抛光剂的清洁剂尤其会损坏下阀杆和上阀杆。



标准维护所需工具：

- 1 x 扳手，开口宽度 SW13、SW24、SW30、SW32
- 1 x 扳手，开口宽度 SW36
- 2 x 扳手，开口宽度 SW17
- 1 x 内六角扳手，开口宽度 SW3、SW6
- 带 45° 尖头的长钩或尖嘴钳
- 夹取工具，以取出 O 型圈和弹性体密封件
- 双鲤鱼钳
- 安装杆 D4，用于安装下阀杆密封件，请见第 25 页
- 用于下阀杆密封件的拆卸和安装工具，请见第 25 页
- 中间密封件安装工具，请见第 26 页
- 阀座密封件的安装工具，请见第 27 页
- 2 个 M8 长六角螺钉，用于安全拆卸阀芯
- SPX FLOW 可提供完整的密封套件以进行阀门维护（见备件清单）。



注意！

必须确保使用与产品、应用和 CIP 清洁剂相兼容的密封材料。如有疑问，请联系您的 SPX FLOW 代理商。

- 更换密封件，请见章节 11.2 至 11.3。
- 在安装之前，所有密封件必须涂上薄薄一层油脂！
建议：
用于 EPDM、HNBR 和 FPM（氟橡胶）的装配油脂
0.75 kg/ 罐 - 参考编号 000 70-01-019/93；H147382
60 g/ 管 - 参考编号 000 70-01-018/93；H147381
- 在安装之前，所有螺丝和螺纹部件均应涂上薄薄一层油脂！
建议： Klüber 油脂膏 UH1 84-201
60 g/ 管 - 参考编号 000 70-01-016/93；H147379
针对驱动器的建议：
气动油脂
25 ml/ 管 - 参考编号 000 70-01-008/93；H164725
- 按照安装说明组装阀门，请见章节 11.3。

11. 拆卸 / 安装说明

产品编号参考备件清单

D4 1.5"-4", DN40-100

RN 500.047.01

D4 6", DN125-150

RN 500.047.03

D4 SL 1.5"-4", DN40-100

RN 501.047.01

D4 SL 6", DN125-150

RN 501.047.03

图 11.1.

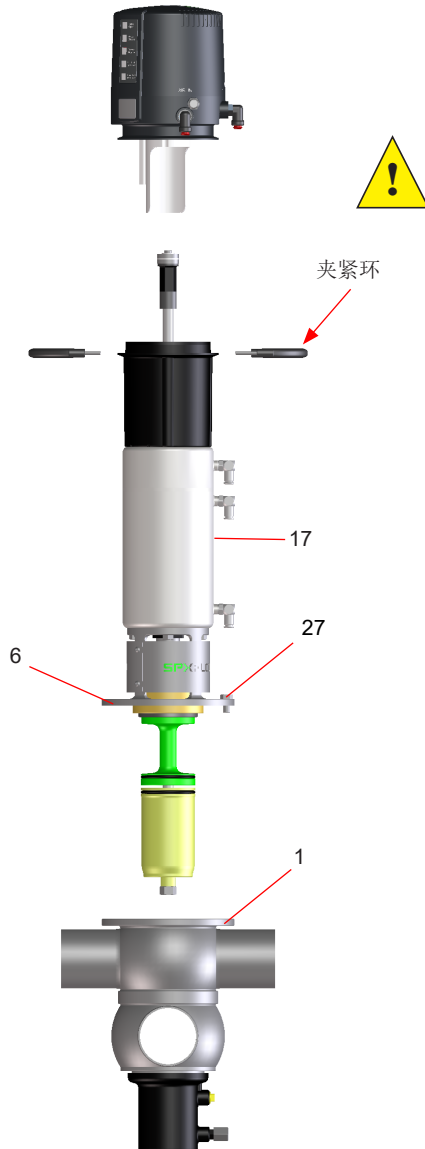

拆卸 / 安装工具，请见第 13 章。

11.1. 从管道系统上拆卸

注意！

1. 关闭产品中的管路压力并清洁管路，如果可能，清空管路。
2. 从阀门驱动 (17) 上拆下控制空气管路。
3. 松开夹紧环上的 2 个螺钉，然后从转接器上卸下控制单元。
4. 带有接近开关支架的型号：
松开接近开关支架上的螺钉并取下接近开关支架。
5. 拆下阀箱 (6) 上的法兰螺钉 (27)。用更长的螺钉替换两个法兰螺钉并将其部分拧入法兰中，以提供额外的安全性。拧入长螺钉之后，便可以安全地取下另外两个法兰螺钉。
6. 将法兰螺钉 (27) 拧入法兰封板 (6) 上的螺纹孔中。结果，整个阀芯略微升起。不要取下螺钉。其将作为装配辅助工具，用于阀芯的后续安装。
7. 从阀体 (1) 夹紧环上垂直取下阀芯。

11. 拆卸 / 安装说明

图 11.2.

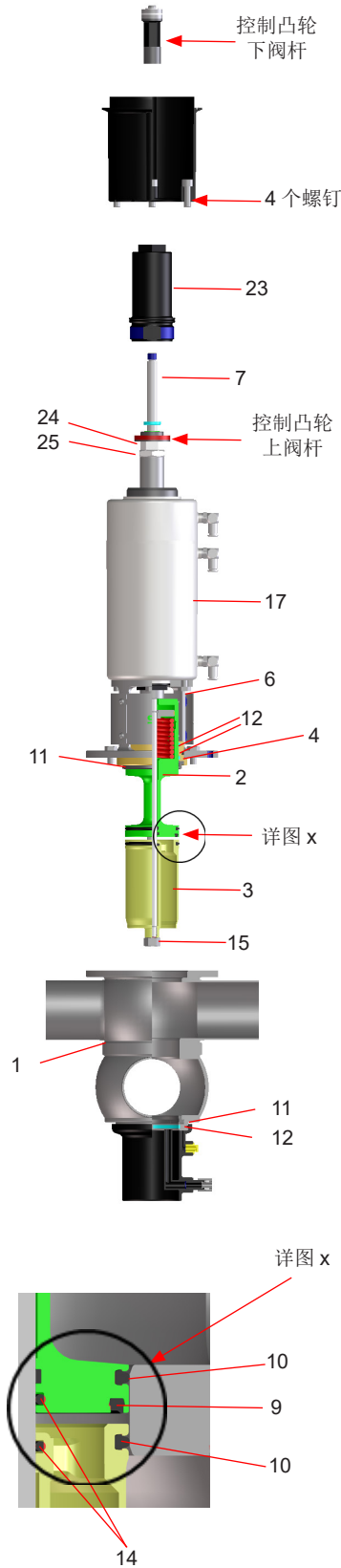

拆卸 / 安装工具，请见第 13 章。

11.2. 拆卸与产品接触的部件

1. 从拉杆 (7) 上取下控制凸轮。
2. 若要卸下转接器，请拆下 4 个螺钉。
3. 松开下锁紧螺母 (15)。在下阀杆 (3) 上用开口宽度 SW17 的扳手固定，防止一起转动。
4. 拆下螺母 (15) 后，拆除下阀杆 (3)。
5. 使用尖头工具插入阀座密封 (10) 中，然后将密封从槽中取出。从槽中取出方形环 (14)。
6. 取下止动螺钉 (23)。
7. 向上拔出拉杆 (7)。
8. 从上阀杆上拆下控制凸轮。
9. 拧下锁紧螺母 (24)。用开口宽度 SW30 的扳手加以固定，防止锁紧环 (25) 一起转动。拆下锁紧环。
10. 提起驱动器 (17) 及阀箱 (6)。
11. 将阀杆轴承 (4) 推到上阀杆平衡器 (2) 上。
12. 从槽中取出阀杆密封 (11)、DN125/150.6" (也适用于 11.1) 和导向环 (12)。
13. 拆下上阀杆密封件
使用尖头工具插入阀座密封 (10) 和中间密封 (9)，然后将密封件从槽中拉出。从槽中取出方形环 (14)。
14. 从外壳上拆除下阀杆密封
使用拆卸工具的金属尖头插入阀杆密封 (11) 中，然后向上将其从外壳 (1) 中拉出。
15. 仅适用于公称尺寸 DN40-100, 1.5"-4"：将钩形工具的金属尖头放入导向环 (12) 的间隙中。轻轻转动钩形工具，将导向环 (12) 从槽和外壳 (1) 中拉出。

11. 拆卸 / 安装说明

图 11.3.

拆卸 / 安装工具，请见第 13 章。

11.3. 安装与产品接触的密封并组装阀门

提示！ 产品区域中的所有密封件和运行表面必须在装配前进行润滑！

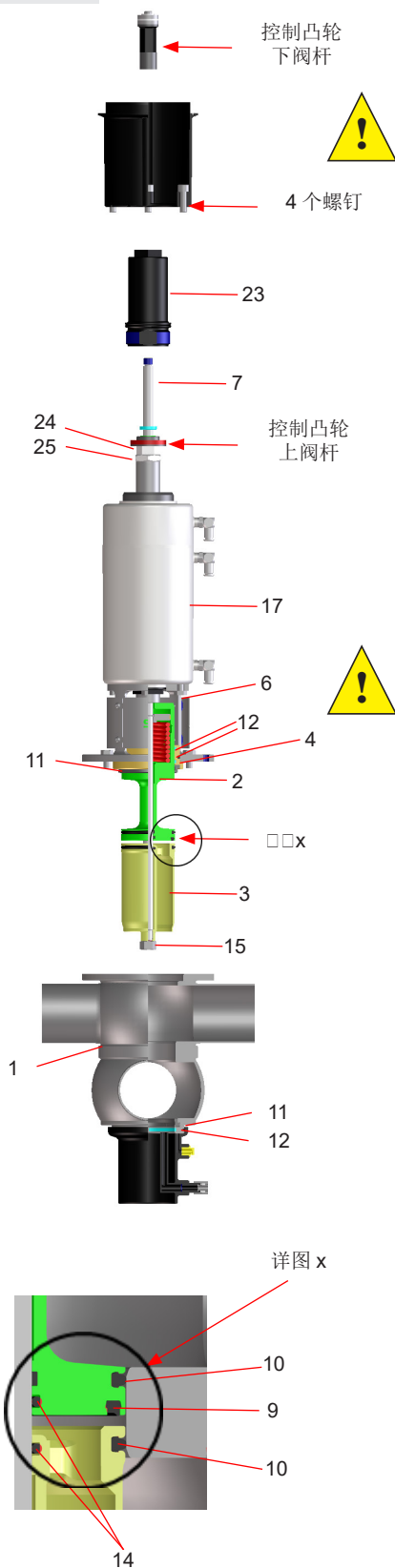

1. 仅适用于公称尺寸 DN40-100, 1.5"-4"：使用双鲤鱼钳或尖嘴钳安装外壳下法兰 (1) 中的导向环 (12)。
 2. 将下阀杆密封 (11) 以及 DN125/150.6"(11.1) 安装在下部外壳法兰中。对于较小的公称尺寸，我们建议使用 2 个安装工具，请见第 13 章。
 3. 将方形环 (14) 安装在上阀杆 (2) 和下阀杆 (3) 中。
 4. 用安装工具将中间密封 (9) 安装在上阀杆 (3) 中 (请见章节 13.2)
 5. 将 2 个阀座密封 (10) 安装到上阀杆 (2) 和下阀杆 (3) 的槽中。
 6. 将阀杆密封 (11) 和两个导向环 (12) 装入阀杆轴承 (4)。
 7. 将阀杆轴承 (4) 推到上阀杆平衡器 (2) 上。
 8. 将上阀杆 (2) 和阀杆轴承 (4) 推过阀箱 (6) 和驱动器 (17)。
 9. 校准滑键，并用锁紧环 (25) 和锁紧螺母 (24) 固定上阀杆 (2)。用开口宽度 SW30 的扳手固定锁紧环 (25)，防止锁紧环一起转动。拧紧扭矩： $M_d = 40 \text{ Nm}$
- 注意！ 锁紧螺母拧得太紧可能会导致上阀杆的螺纹损坏。
10. 将控制凸轮拧到上阀杆上。
 11. 确保滑键紧卡在拉杆上。将拉杆 (7) 从上方插入驱动器 (17)，直至其停止。
 12. 将下阀杆 (3) 推到拉杆 (7) 上，并用六角螺母 (15) 固定。
拧紧扭矩： $M_d = 40 \text{ Nm}$
 13. 将下阀杆 (3) 推到拉杆 (7) 上。将下阀杆对准滑键并用锁紧螺母 (15) 拧紧。拧紧止动螺钉 (23)，直至其停止。拧紧扭矩： $M_d = 10 \text{ Nm}$
止动螺钉必须与套管 (D4) 或活塞 (D4 SL) 齐平。
 14. 用 4 个螺钉将转接器固定在驱动器上，并确保控制单元上的压缩空气接头已对准 D4 阀门上的压缩空气接头。
 15. 将控制凸轮拧紧到导杆 (7) 上。

11. 拆卸 / 安装说明

图 11.4.

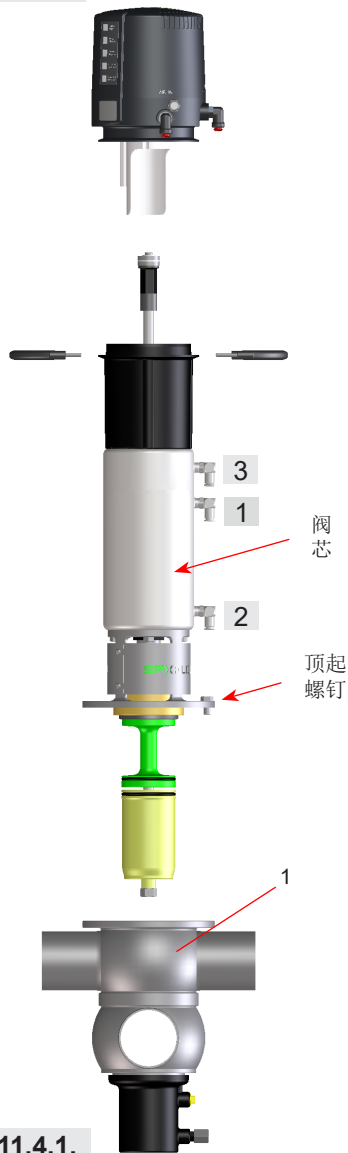

11.4. 安装阀芯

1. 将阀芯小心插入阀体 (1)，直至其停止。
2. 卸下顶起螺钉并将阀芯小心推入外壳 (1)。
3. 拧入六角螺栓 (26)，并交叉拧紧。
4. 将控制单元放在转接器上。控制单元必须在转接器上对中。
5. 放上夹紧环，并用螺钉固定。

6. 安装控制空气管路。

D4 阀门： 空气接口 1：打开阀门

D4 SL 阀门： 空气接口 1：打开阀门
空气接口 2： 上阀杆通风
空气接口 3： 下阀杆通风

7. 检查阀门位置反馈：

阀门关闭位置信息 - 传感器 1 已启动

若要设置霍尔传感器 1，阀门必须处于关闭位置；电磁阀未启动。将调节螺钉 1 转到所需位置。“Valve Closed”（阀门关闭）LED 亮起。

阀门打开位置信息 - 传感器 2 已启动

若要设置霍尔传感器 2，首先启动电磁阀 1。这可以手动或电动完成。然后转动调节螺钉 1，设置阀门打开位置和相应反馈。当达到所需位置时，“Valve Open”（阀门打开）LED 亮起

请注意霍尔效应传感器的开关滞后现象！

因此应设置重叠的传感器开关点，以允许较小的波动。我们建议将调整螺钉额外调整 2 x 360° 转。

8. 带接近开关的型号：

放置接近开关支架并用螺钉拧紧。检查是否显示消息“Valve Closed”（阀门关闭）或“Valve Open”（阀门打开）。如有必要，定位接近开关。

图 11.4.1.

D4 / D4 SL 带阀门位置反馈

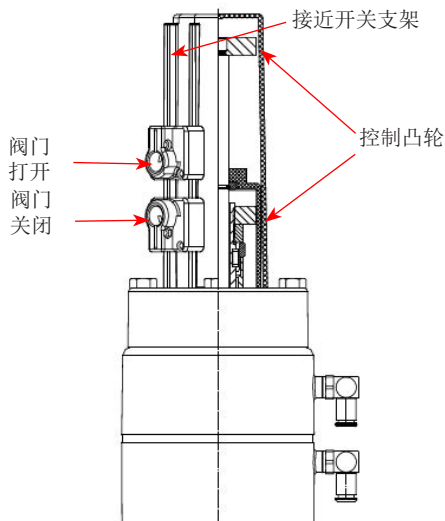

12. 驱动器的维护

图 12. : D4 阀门驱动



产品编号参考备件清单

D4 1.5"-4", DN40-100	RN 500.047.01
D4 6", DN125-150	RN 500.047.03
D4 SL 1.5"-4", DN40-100	RN 501.047.01
D4 SL 6", DN125-150	RN 501.047.03

12.1 拆卸驱动螺杆

1. 取下阀箱护盖和阀箱。
2. 用开口宽度 SW36 的套筒扳手拧开两个驱动螺杆 (19)。
3. 拆下 V 形密封圈 (20) 和 O 型圈 (18)。

12.2 安装密封和组装驱动器

1. 在驱动螺杆 (19) 上安装略微涂油的 O 型圈 (18) 和 V 形密封圈 (20)。检查并确认 V 形密封圈 (20) 的安装位置正确。

针对驱动器的建议：

气动油脂

(25 ml/ 管 - 参考编号 000 70-01-008/93 ; H164725)

2. 将安装工具 (H338580) 放在活塞杆的端部。在驱动器两侧，用开口宽度 SW36 的套筒扳手将驱动螺杆 (19) 拧在活塞杆上并加以固定。

1. 重新安装阀箱护盖和阀箱。

图 12. : D4 SL 阀门驱动

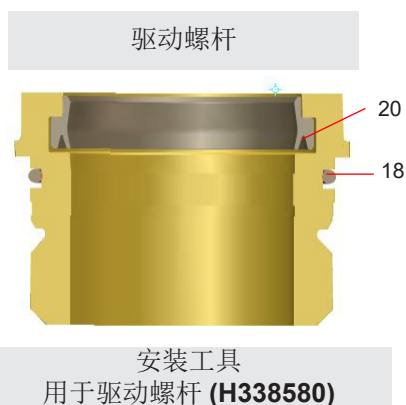
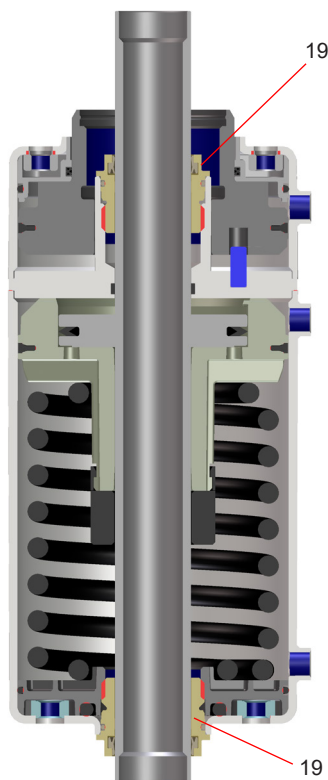

13. 密封装配说明和安装工具

13.1. 下阀杆密封

安装工具
(H171889)

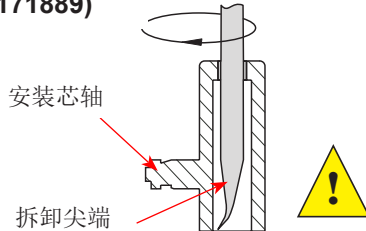

安装杆
(H338450)

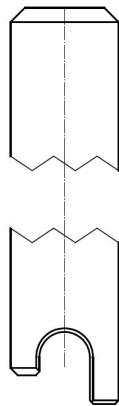

为便于完成下阀杆密封 (11) 的拆卸和组装, 请使用组合工具 (H171889) 和安装杆 (H338450)。特别是对于小型系列 (DN 40–65, 1.5"-3") 的阀门, 建议使用该工具, 因为由于紧配合而无法从上方接触到下阀杆密封。

注意! 为避免人员受伤, 在不使用时, 拆卸尖端必须用安装芯轴加以遮盖保护。

1. 在密封圈 (11) 上略微涂上油脂。
2. 使用安装工具, 将阀杆密封从上面插入, 首先从宽边开始, 穿过壳体中间环, 然后插入到下部壳体 (图 1)。
3. 将阀杆密封 (11) 与安装芯轴的安装槽对齐。
4. 在外壳法兰槽的一个点上压入阀杆密封 (11), 然后再进一步按压阀杆密封。
5. 将安装杆的安装槽定位在密封唇上。轻轻转动安装杆并将阀杆密封 (11) 放入槽中。在密封唇周围继续使用工具, 并以相同方式插入阀杆密封, 直至阀杆密封完全位于槽中。

1.

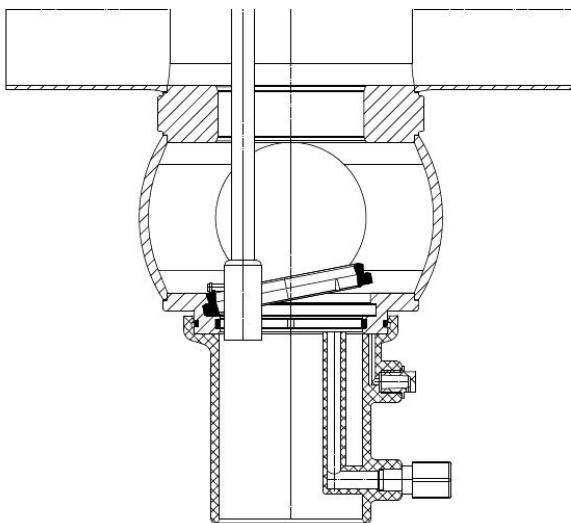

2.

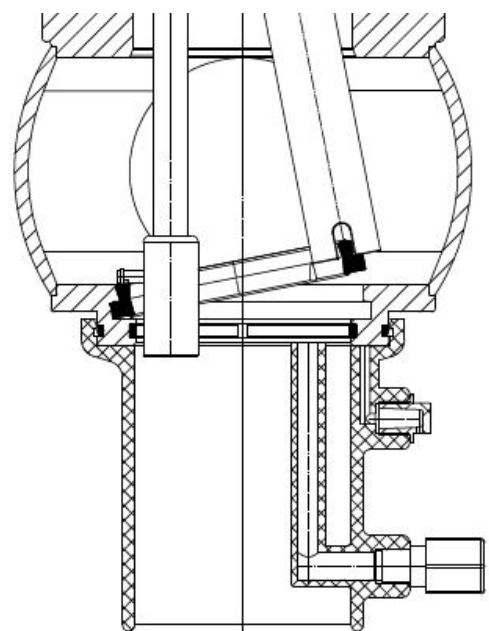

13. 密封装配说明和安装工具

13.2. 中间密封

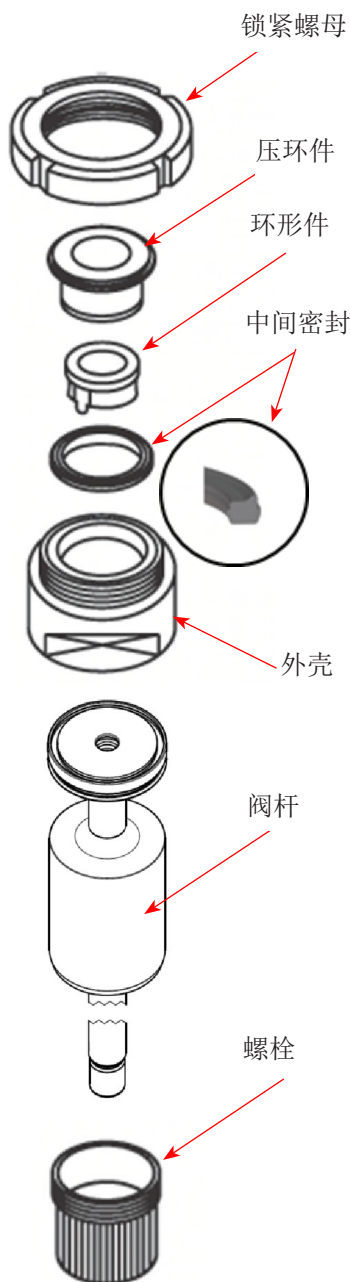

安装部件包括：

- 锁紧螺母
- 压环件
- 带排气口的圆环件
- 外壳
- 螺栓

在阀杆上安装中间密封圈

1. 将阀杆插入壳体，使密封槽位于壳体内。
2. 用螺栓将阀杆固定在壳体中。将外壳夹在虎钳中。
3. 在中间密封上略微涂上装配油脂。然后将密封圈放在环形件上。
4. 将带有中间密封圈的环形件插入外壳中。排气口件位于密封槽内。
5. 将压环件围绕环形件插入壳体。拧上锁紧螺母并使用钩形扳手拧紧，直到其停止。
6. 松开锁紧螺母。将环形件和压环件从外壳中取出。
7. 从虎钳上松开外壳，拧下螺栓。将阀杆从外壳中取出检查并确认中间密封位置正确。

中间密封的安装部件

DN	英寸	名称	参考编号
40	1.5"	DA3 - 62	51 - 13 - 210/17 H207310
50	2"		
65	2.5" 3"		
80	4"	DA3 - 92	51 - 13 - 211/17 H207311
100			
125		D4 - 114	51-13-675/17 H340758
150	6"	D4 - 138	51-13-677/17 H340823

13. 密封装配说明和安装工具

13.3. 阀座密封

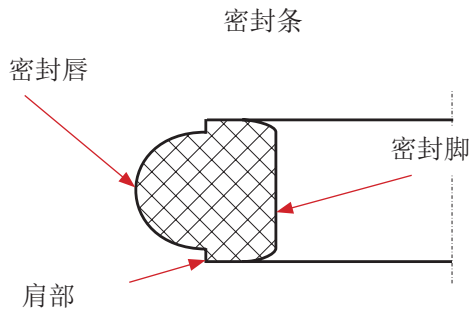

注意!
密封件肩部必须干净地放在定位槽中。

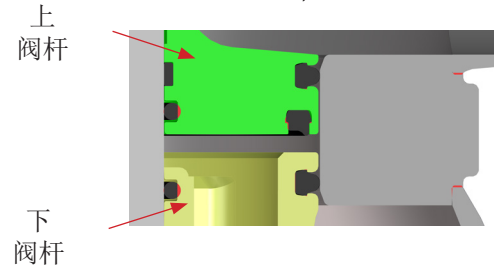

1. 将密封件肩部涂上薄薄一层油脂。

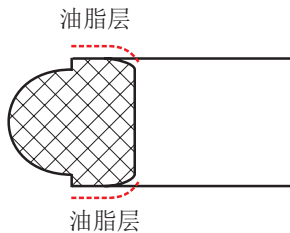

2. 将阀座密封圈安装在阀杆上，确保均匀的倾斜度。

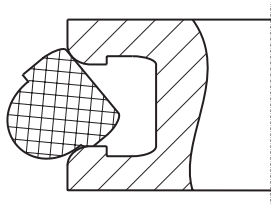

3. 使用安装工具（也可以使用带圆边的螺丝刀），将密封垫一直压入凹槽中。为此，安装工具应放置在上密封件肩部。为确保密封均匀，应该逐步进行操作：

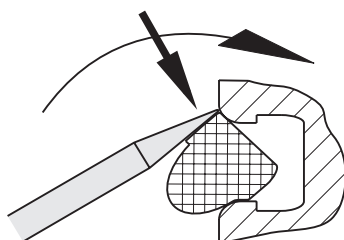

3.1. 将一小段密封压入凹槽。

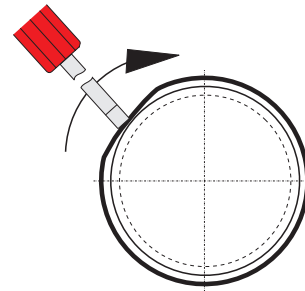

3.2. 用手指固定已压入的密封圈（否则会松脱）。沿手指方向，使用安装工具按压较短区域的密封件。沿整个圆周安装密封件。

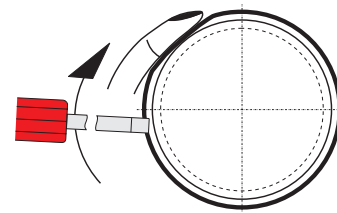

4. 在密封件肩部和槽侧面（两侧）之间压入安装工具并完整地连续压入。然后绕圈压入下密封件肩部。这样的话，可以确保凹槽底部的空气被排空并且密封件肩部接合紧密。

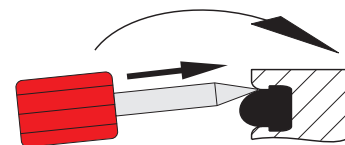

14. 故障排除

故障	阀门位置		需要更换密封件
	关闭	打开	
上外壳法兰或阀箱上存在泄漏	x	x	上阀杆密封 (11)
下阀杆内侧泄漏	x		阀座密封 (10)
下阀杆内侧泄漏		x	中间密封 (9)
下阀杆外侧泄漏 (为此拆除喷射连接)	x	x	下阀杆密封 (11)

产品编号请参考备件清单。

15. 备件清单

可在随附的备件图纸和相应的清单中查找各种阀门型号和尺寸的备件参考编号。

请注意，**D4** 阀门和 **D4 SL** 阀门（标准和大型公称尺寸）的备件清单各有不同。在本操作说明的附录中，您会看到四份单独的备件清单。

订购备件时，请提供以下数据：

- 需要的零件数量
- 参考编号
- 名称

保留更改权利

Information contained in this document is subject to change without notice and does not represent a commitment on the part of SPX FLOW, Inc.. No part of this document may be reproduced or transmitted in any form or by any means, electronic or mechanical, including photocopying and recording, for any purpose, without the express written permission of SPX FLOW, Inc..

Spare Parts List

Double seat mix proof valve D4 1.5" - 4" ; DN 40 - 100

Date:	16.3.18	30.10.18	SPX FLOW	
Name:	C. Keil	C. Keil		
Reviewed:				
Date:			Page 1 of 9	
Name:				
Reviewed:				RN 500.047.01

Pos:34/35 please refer to CU4 manual

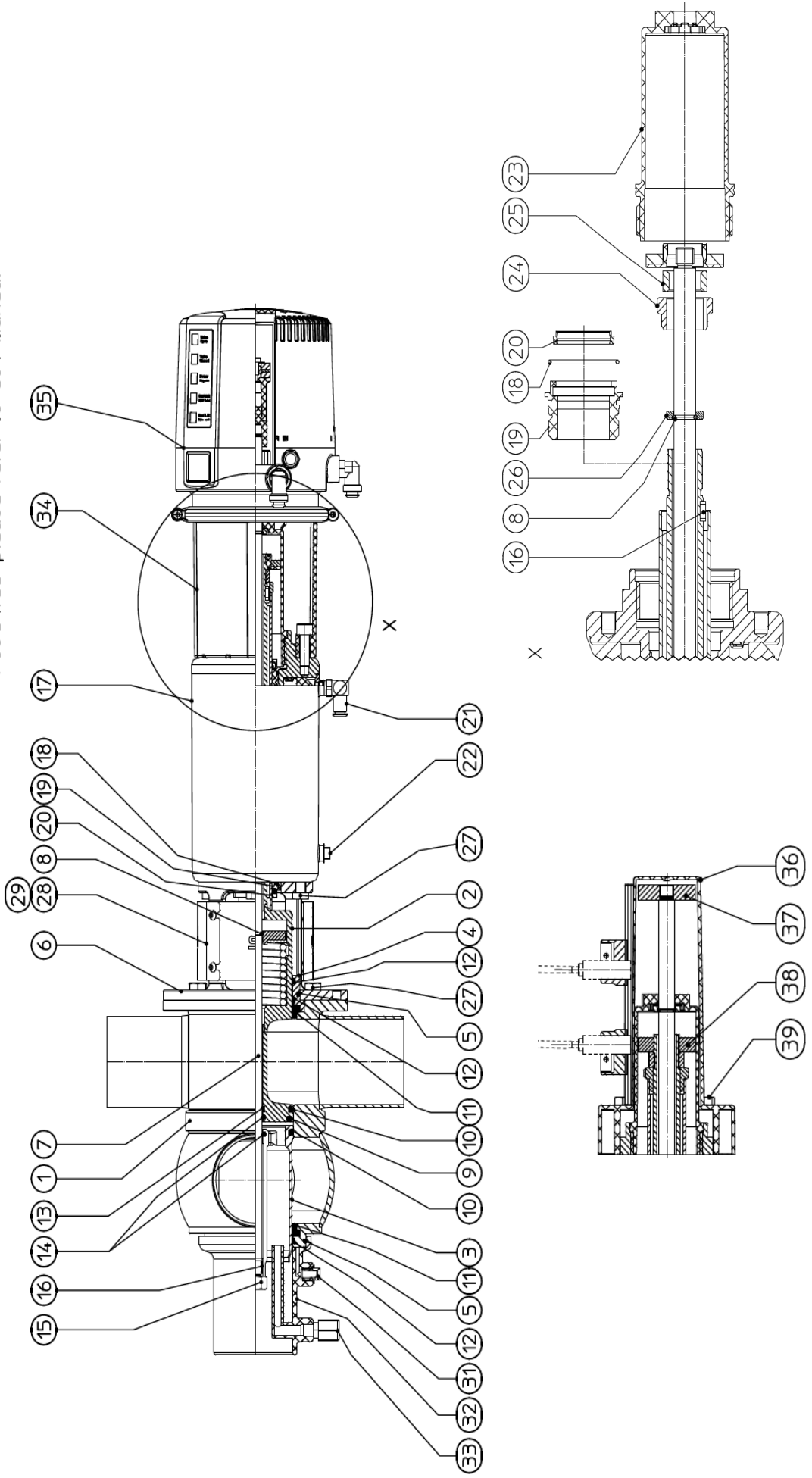

Information contained in this document is subject to change without notice and does not represent a commitment on the part of SPX FLOW, Inc.. No part of this document may be reproduced or transmitted in any form or by any means, electronic or mechanical, including photocopying and recording, for any purpose, without the express written permission of SPX FLOW, Inc..

Spare parts list

Double seat mix proof valve D4 1.5" - 4"; DN 40 - 100

Pos. Item	Quantity	Description	included in spare parts (pos.)	Material	DN40	1.5"	DN50	2"	DN65	SPX FLOW	
					Reference no. Part no.	Reference no. Part no.	Reference no. Part no.	Reference no. Part no.	Reference no. Part no.	Reference no. Part no.	Page 3 of 9
	2	Seat seal		EPDM			000 58-33-132/93 H168192				
10	2	Seat seal		HNBR			000 58-33-132/33 H171561				
	2	Seat seal		FPM			000 58-33-132/73 H171559				
	2	Shaft seal		EPDM			000 58-33-400/93 H337476				
11	2	Shaft seal		HNBR			000 58-33-400/33 H337478				
	2	Shaft seal		FPM			000 58-33-400/73 H337477				
12	3	Guide ring		Iglidur A500			000 58-01-610/99 H334863				
13	1	Guide band		Acoflon			000 08-39-380/99 H334865				
14	1	Quad ring 12,37x 2,62		EPDM			000 58-01-049/63 H311646				
15	2	Hex. Screw M10x1		A2			000 65-50-087/15 H118903				
16	2	Square key DIN6885 - A - 3x3x10		A2			000 29-02-190/17 H335171				
17	1	Actuator	18, 19, 20	1.4301	000 29-02-178/17 H335446		000 29-02-179/17 H335443		000 29-02-180/17 H334365		
18	2	O-ring 30 x 2,5		NBR			000 58-06-113/83 H337897				
19	2	Actuator screw		Iglidur J350			000 16-28-330/93 H334376				
20	2	V-seal		NBR			000 58-01-600/73 H334379				

Information contained in this document is subject to change without notice and does not represent a commitment on the part of SPX FLOW, Inc.. No part of this document may be reproduced or transmitted in any form or by any means, electronic or mechanical, including photocopying and recording, for any purpose, without the express written permission of SPX FLOW, Inc..

Spare parts list

Double seat mix proof valve D4 1.5" - 4" ; DN 40 - 100

Pos. Item	Quantity	Description	included in spare parts (pos.)	Material	DN40	1.5"	DN50	2"	DN65	SPX FLOW	
					Reference no. Part no.	Reference no. Part no.	Reference no. Part no.	Reference no. Part no.	Reference no. Part no.	Reference no. Part no.	Page 4 of 9
21	3	W-union G1/8" Ø6mm		hard nickel-plated			000 08-60-750/93 H208825				
22	1	Venting plug G-1/8"		PE-Hard			000 08-60-005/93 H16218				
23	1	Stop screw		Grivory			000 16-28-340/39 H334382				
24	1	Lock washer D4		1.4301			000 67-03-030/12 H335172				
25	1	Safety nut D3		1.4301			000 65-50-137/15 H147640				
26	1	Thrust ring		1.4057			000 08-48-106/12 H123151				
27	8	Hex. screw M8 x 16		A2			000 65-01-081/15 H78772				
28	1	Yoke cover D4	29	1.4301			000 16-40-220/00 H341311				
29	4	Savetix head screw M4 x 8 washer M4 as set		1.4301			000 65-06-010/12 H336707				
30											
31	1	Venting plug G-1/8"		PE-Hard			000 08-74-014/93 H16507				
32	1	Spray connection DE3		PP			000 09-40-114/93 H168321				
33	1	G-union 8x1-G1/8"		PVDF-black			000 08-63-003/13 H16388				
34	1	CU4 D4 adapter cmpl.		PA6.6 GF30 black			000 08-46-646/93 H337098				
	1	CU4plus D4 V1 adapter cmpl.		PA6.6 GF30 black			000 08-46-666/93 H336441				

Information contained in this document is subject to change without notice and does not represent a commitment on the part of SPX FLOW, Inc.. No part of this document may be reproduced or transmitted in any form or by any means, electronic or mechanical, including photocopying and recording, for any purpose, without the express written permission of SPX FLOW, Inc..

Spare parts list

Double seat mix proof valve D4 1.5" - 4"; DN 40 - 100

		Date:	16.3.18	07.10.19	21.08.20	SPX FLOW								
		Name:	C.Keil	Size-Si	C.Keil									
		Reviewed:												
		Date:				Page	5 of 9							
		Name:				RN 500.047.01								
		Reviewed:												
Pos.	Item	Quantity	Description	included in spare parts (pos.)	Material	DN40	1.5"	DN50	2"	DN65	Reference no.	Part no.	Reference no.	Part no.
		1	CU41 D4 DC ø6mm		PA 6.6 GF30 black			000 08-45-380/93 H336954						
		1	CU41 D4 M12 DC ø6mm		PA 6.6 GF30 black			000 08-45-570/93 H341342						
		1	CU41 D4 AS-i Ext. ø6mm		PA 6.6 GF30 black			000 08-45-382/93 H336956						
		1	CU41 D4 M12 AS-i Ext. ø6mm		PA6.6 GF30 black			000 08-45-386/93 H338878						
35		1	CU41 D4 AS-i Std. ø6mm		PA 6.6 GF30 black			000 08-45-384/93 H338150						
		1	CU41 D4 M12 AS-i Std. ø6mm		PA 6.6 GF30 black			000 08-45-388/93 H338898						
		1	CU41plus D4 V1 AS-i Ext. ø6mm		PA6.6 GF30 black			000 08-45-555/93 H338819						
		1	CU41plus D4 V1 M12 AS-i Ext. ø6mm		PA6.6 GF30 black			000 08-45-339/93 H338864						
36		1	Prox. switch holder D4 compl.		PA 6.6 GF30 black			000 16-33-050/93 H336751						
37		1	Operating cam D4 bottom		1.4523 / 444FR			000 08-60-461/99 H334386						
38		1	Operating cam D4 top		1.4523 / 444FR			000 08-60-460/99 H334387						
39		4	Hex. screw M8x40		A2-70			000 65-01-086/15 H336675						
Pos. 9, 10, 11, 12, 14 available as complete seal kits only														
		1	Seal kit		EPDM			000 58-38-005/01 H337884						
		1	Seal kit		FPM			000 58-38-005/00 H337886						
		1	Seal kit		HNBR			000 58-38-005/06 H337885						

Information contained in this document is subject to change without notice and does not represent a commitment on the part of SPX FLOW, Inc.. No part of this document may be reproduced or transmitted in any form or by any means, electronic or mechanical, including photocopying and recording, for any purpose, without the express written permission of SPX FLOW, Inc..

Spare parts list

Double seat mix proof valve D4 1.5" - 4"; DN 40 - 100

Date: 16.3.18 07.10.19		C. Keil Sze-Si		SPX FLOW							
Name:		Reviewed:		Page 6 of 9							
Date:		Reviewed:		RN 500.047.01							
Name:		Reviewed:									
Pos. Item	Quantity	Description	included in spare parts (pos.)	Material	3"	DN80	DN100	4"	Reference no. Part no.	Reference no. Part no.	Reference no. Part no.
1	1	Housing D41 1-6		1.4404	000 16-61-562/47 H337188	000 16-61-537/47 H337183	000 16-61-637/47 H337184	000 16-61-662/47 H337189			
	1	Housing D41 1-7		1.4404	000 16-61-572/47 H337178	000 16-61-547/47 H337173	000 16-61-647/47 H337174	000 16-61-672/47 H337179			
	1	Housing D41 1-8		1.4404	000 16-61-566/47 H337198	000 16-61-541/47 H337193	000 16-61-641/47 H337194	000 16-61-666/47 H337199			
	1	Housing D42		1.4404	000 16-62-572/47 H337031	000 16-62-547/47 H337026	000 16-62-647/47 H337027	000 16-62-672/47 H337032			
2	1	Housing D43		1.4404	000 16-63-572/47 H337041	000 16-63-547/47 H337036	000 16-63-647/47 H337037	000 16-63-672/47 H337042			
	1	Housing D44		1.4404	000 16-64-572/47 H335275	000 16-64-547/47 H335278	000 16-64-647/47 H335279	000 16-64-672/47 H335280			
3	1	Upper valve shaft	13, 16, 25	1.4404	000 16-25-565/00 H341258	000 16-25-540/00 H341257	000 16-25-640/00 H341259				
4	1	Lower valve shaft		1.4404	000 16-25-564/42 H335392	000 16-25-539/42 H335393	000 16-25-639/42 H335394				
5	1	Shaft bearing		1.4404	000 16-28-300/12 H334381	000 16-28-300/12 H335713					
6	2	O-ring		EPDM	000 58-06-295/64 H77039	000 58-06-490/63 H77061					
7	1	Yoke		1.4301	000 16-40-200/12 H334383	000 16-40-209/12 H335994					
8	1	Guide rod	8, 15, 16	1.4404	000 16-25-561/00 H341287	000 16-25-536/ H341286	000 16-25-636/00 H341288				
9	2	Retainer ring		1.4310	000 08-39-083/13 H14883						
9	1	Middle seal		EPDM	000 58-33-998/93 H327602	000 58-33-997/93 H327985					
	1	Middle seal		HNBR	000 58-33-998/33 H332652	000 58-33-997/33 H332649					
	1	Middle seal		FPM	000 58-33-998/71 H332653	000 58-33-997/71 H332648					

Information contained in this document is subject to change without notice and does not represent a commitment on the part of SPX FLOW, Inc.. No part of this document may be reproduced or transmitted in any form or by any means, electronic or mechanical, including photocopying and recording, for any purpose, without the express written permission of SPX FLOW, Inc..

Spare parts list

Double seat mix proof valve D4 1.5" - 4"; DN 40 - 100

		Date: 20.3.18 07.10.19 21.08.20		SPX FLOW						
		Name: C. Keil Sze-Si C. Keil								
		Reviewed:		Page 9 of 9						
		Date:		RN 500.047.01						
		Name:								
		Reviewed:								
Pos. Item	Quantity	Description	included in spare parts (pos.)	Material	3" Reference no. Part no.	DN80 Reference no. Part no.	DN100 Reference no. Part no.	4" Reference no. Part no.	Reference no. Part no.	Reference no. Part no.
	1	CU41 D4 DC ø6mm		PA 6.6 GF30 black	000 08-45-380/93 H336954					
	1	CU41 D4 M12 DC ø6mm		PA 6.6 GF30 black	000 08-45-570/93 H341342					
	1	CU41 D4 AS-i Ext. ø6mm		PA 6.6 GF30 black	000 08-45-382/93 H336956					
	1	CU41 D4 M12 AS-i Ext. ø6mm		PA6.6 GF30 black	000 08-45-386/93 H338878					
34	1	CU41 D4 AS-i Std. ø6mm		PA 6.6 GF30 black	000 08-45-384/93 H338150					
	1	CU41 D4 M12 AS-i Std. ø6mm		PA 6.6 GF30 black	000 08-45-388/93 H338898					
	1	CU41plus D4 V1 AS-i Ext. ø6mm		PA6.6 GF30 black	000 08-45-555/93 H338819					
	1	CU41plus D4 V1 M12 AS-i Ext. ø6mm		PA6.6 GF30 black	000 08-45-339/93 H338864					
35	1	Prox. switch holder D4 compl.		PA 6.6 GF30 black	000 16-33-050/93 H336751					
36	1	Operating cam D4 top		1.4523 / 444FR	000 08-60-460/99 H334387					
37	1	Operating cam D4 bottom		1.4523 / 444FR	000 08-60-461/99 H334386					
38	1	Operating cam D4 top		1.4523 / 444FR	000 08-60-460/99 H334387					
Pos. 9, 10, 11, 12, 14 available as complete seal kits only										
	1	Seal kit		EPDM	000 58-38-005/01 H337884				000 58-38-006/01 H337887	
	1	Seal kit		FPM	000 58-38-005/00 H337886				000 58-38-006/00 H337889	
	1	Seal kit		HNBR	000 58-38-005/06 H337885				000 58-38-006/06 H337888	

Information contained in this document is subject to change without notice and does not represent a commitment on the part of SPX FLOW, Inc.. No part of this document may be reproduced or transmitted in any form or by any means, electronic or mechanical, including photocopying and recording, for any purpose, without the express written permission of SPX FLOW, Inc..

Spare Parts list

Double seat mix proof valve D4 - 125-150-6"

SPX FLOW

Date: 11.10.19
 Name: Sze-Si.
 Reviewed:

10.06.20
 C.Keil
 Page 1 of 5

Date:
 Name:
 Reviewed:

RN 500.047.03

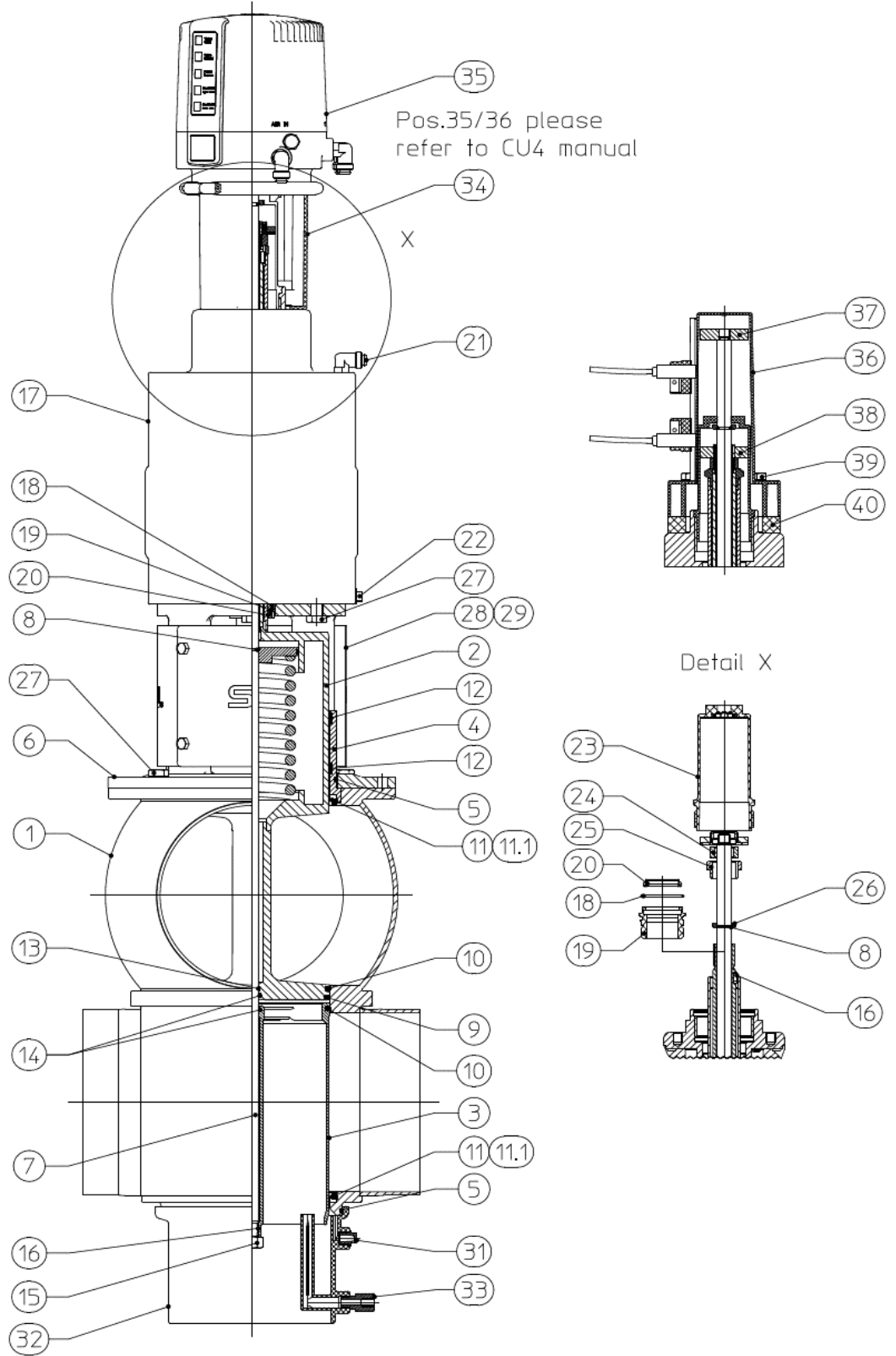

Information contained in this document is subject to change without notice and does not represent a commitment on the part of SPX FLOW, Inc.. No part of this document may be reproduced or transmitted in any form or by any means, electronic or mechanical, including photocopying and recording, for any purpose, without the express written permission of SPX FLOW, Inc..

Spare Parts list

**Double seat mix proof valve
D4 - 125-150-6"**

		Date:	11.10.19												
		Name:	Size-Si.												
		Reviewed:													
		Date:													
		Name:													
		Reviewed:													
												Page	2	of	5
												RN 500.047.03			
Pos.	Qty.	Description	Material	DN125 Reference no. Part no.	DN150 Reference no. Part no.	6" Reference no. Part no.									
	1	Housing D41 / 1-6	1.4404	000 16-61-687/47 H340122	000 16-61-737/47 H340135	000 16-61-762/47 H340141									
	1	Housing D41 / 1-7	1.4404	000 16-61-697/47 H340123	000 16-61-747/47 H340136	000 16-61-772/47 H340142									
1	1	Housing D41 / 1-8	1.4404	000 16-61-691/47 H340124	000 16-61-741/47 H340137	000 16-61-766/47 H340143									
	1	Housing D42	1.4404	000 16-62-697/47 H340121	000 16-62-747/47 H340134	000 16-62-772/47 H340140									
	1	Housing D43	1.4404	000 16-63-697/47 H340120	000 16-63-747/47 H340133	000 16-63-772/47 H340139									
	1	Housing D44	1.4404	000 16-64-697/47 H340119	000 16-64-747/47 H340132	000 16-64-772/47 H340138									
2	1	Upper valve shaft	1.4404	000 16-25-694/00 H341269	000 16-25-694/00 H341270	000 16-25-234/00									
3	1	Lower valve shaft	1.4404	000 16-25-689/42 H340230	000 16-25-689/42 H340311	000 16-25-520/42									
4	1	Shaft bearing	1.4404	000 16-28-302/12 H340243	000 16-28-303/12 H340322	000 16-28-303/12 H340322									
5	2	O-ring	EPDM	000 58-06-555/63 H77074	000 58-06-555/63 H77081	000 58-06-655/63 H77081									
6	1	Yoke	1.4301	000 16-40-202/12 H340244	000 16-40-202/12 H340323	000 16-40-204/12 H340323									
7	1	Guide rod	1.4404	000 16-25-687/00 H341298	000 16-25-687/00 H341298	000 16-25-545/00 H341299									
8	2	Retainer ring	1.4310	08-39-083/13 H14883											
	1	Middle seal	EPDM	000 58-33-996/93 H340247	000 58-33-996/93 H340325	000 58-33-995/93 H340325									
9	1	Middle seal	HNBR	000 58-33-996/33 H340248	000 58-33-996/33 H340326	000 58-33-995/33 H340326									
	1	Middle seal	FPM	000 58-33-996/73 H340294	000 58-33-996/73 H340327	000 58-33-995/73 H340327									

Information contained in this document is subject to change without notice and does not represent a commitment on the part of SPX FLOW, Inc.. No part of this document may be reproduced or transmitted in any form or by any means, electronic or mechanical, including photocopying and recording, for any purpose, without the express written permission of SPX FLOW, Inc..

Spare Parts list

**Double seat mix proof valve
D4 - 125-150-6"**

		Date:	11.10.19												
		Name:	Size-Si.												
		Reviewed:													
		Date:													
		Name:													
		Reviewed:													
												Page	3	of	5
												RN 500.047.03			
pos.	item	Quantity	Description	included in spare parts (pos.)	Material	125 Reference no. Part no.	150 Reference no. Part no.	6" Reference no. Part no.							
		2	Seat seal		EPDM	000 58-33-135/93 H173940	000 58-33-134/93 H173739								
10		2	Seat seal		HNBR	000 58-33-135/33 H173939	000 58-33-134/33 H173738								
		2	Seat seal		FPM	000 58-33-135/73 H340246	000 58-33-134/73 H338070								
		2	Shaft seal		EPDM	000 58-33-693/93 H77611	000 58-33-743/93 H77628								
11		2	Shaft seal		HNBR	000 58-33-693/33 H170178	000 58-33-743/33 H170177								
		2	Shaft seal		FPM	000 58-33-693/73 H77610	000 58-33-743/73 H77627								
11.1		2	PTFE Shaft seal		PTFE	000 58-33-156/23 H340295	000 58-33-157/23 H340328								
12		2	Guide ring		Igildur A500	000 58-01-614/99 H340198	000 58-01-613/99 H340182								
13		1	Guide band		Acoflon	000 08-39-380/99 H334865									
14		2	Quad ring 12,37x 2,62		EPDM	000 58-01-049/63 H311646									
15		2	Hex. Screw M10x1		A2	000 65-50-087/15 H118903									
16		2	Square key DIN6885 - A - 3x3x10		A2	000 29-02-190/17 H335171									
17		1	Actuator	18, 19, 20	1.4301	000 29-02-202/17 H340639	000 29-02-201/17 H340636								
18		2	O-ring 30 x 2,5		NBR	000 58-06-113/83 H337897									
19		2	Actuator screw		Igildur J350	000 16-28-330/93 H334376									
20		2	V-seal		NBR	000 58-01-600/73 H334379									

Information contained in this document is subject to change without notice and does not represent a commitment on the part of SPX FLOW, Inc.. No part of this document may be reproduced or transmitted in any form or by any means, electronic or mechanical, including photocopying and recording, for any purpose, without the express written permission of SPX FLOW, Inc..

Spare Parts list

Double seat mix proof valve D4 - 125-150-6"

pos. item		Quantity	Description	included in spare parts (pos.)	Material	125		150		6"		Reference no. Part no.	Reference no. Part no.
						Reference no. Part no.	Reference no. Part no.	Reference no. Part no.	Reference no. Part no.				
21	1	W-union G1/8" Ø6mm			hard nickel-plated			000 08-60-750/93 H208825					
22	1	Venting plug G-1/8"			PE-Hard			000 08-60-005/93 H16218					
23	1	Stop screw			Grivory			000 16-28-340/39 H334382					
24	1	Safety nut D3			1.4301			000 65-50-137/15 H147640					
25	1	Lock washer D4			1.4301			000 67-03-030/12 H335172					
26	1	Thrust ring			1.4057			000 08-48-106/12 H123151					
27	8	Hex. screw M10 x 20			A2			000 65-01-134/13 H340472					
28	1	Yoke cover D4		29	1.4301		000 16-40-226/00 H341313	000 16-40-227/00 H341314					
29	4	Savetix head screw M6 x 8 washer M6 as set			1.4301			000 65-06-011/12 H340632					
30													
31	1	Venting plug G-1/8"			PE-Hard			000 08-74-014/93 H16507					
32	1	Spray connection DE3			PP		000 09-40-117/93 H178450	000 09-40-118/93 H200320					
33	1	G-union 10/8-G1/4" with supp. Sleeve cpl.			1.4571			000 16-38-200/42 H329696					
34	1	CU4 D4 adapter cmpl.			PA6.6 GF30 black			000 08-46-646/93 H337098					
	1	CU4plus D4 V1 adapter cmpl.			PA6.6 GF30 black			000 08-46-666/93 H336441					

Information contained in this document is subject to change without notice and does not represent a commitment on the part of SPX FLOW, Inc.. No part of this document may be reproduced or transmitted in any form or by any means, electronic or mechanical, including photocopying and recording, for any purpose, without the express written permission of SPX FLOW, Inc..

Spare Parts list

Double seat mix proof valve D4 - 125-150-6"

Date:	11.10.19	21.08.20	
Name:	Sze-Si.	C.Keil	
Reviewed:			
Date:			Page 5 of 5
Name:			RN 500.047.03
Reviewed:			

SPX FLOW

pos. item	Quantity	Description	included in spare parts (pos.)	Material	125		150		6"	
					Reference no. Part no.	Reference no. Part no.	Reference no. Part no.	Reference no. Part no.		
	1	CU41 D4 DC ø6mm		PA6.6 GF30 black		000 08-45-380/93 H336954				
	1	CU41 D4 M12 DC ø6mm		PA6.6 GF30 black		000 08-45-570/93 H341342				
	1	CU41 D4 AS-i Ext. ø6mm		PA6.6 GF30 black		000 08-45-382/93 H336956				
35	1	CU41 D4 M12 AS-i Ext. ø6mm		PA6.6 GF30 black		000 08-45-386/93 H338878				
	1	CU41plus D4 V1 AS-i Ext. ø6mm		PA6.6 GF30 black		000 08-45-555/93 H338819				
	1	CU41plus D4 V1 M12 AS-i Ext. ø6mm		PA6.6 GF30 black		000 08-45-339/93 H338864				
36	1	Prox. switch holder D4 compl.		PA6.6 GF30 black		000 16-33-050/93 H336751				
37	1	Operating cam D4 bottom		1.4523 / 444FR		000 08-60-461/99 H334386				
38	1	Operating cam D4 top		1.4523 / 444FR		000 08-60-460/99 H334387				
39	4	Hex. Screw		A2-70		000 65-01-086/15 H336675		000 65-01-087/15 H340751		
40	1	Spacer		PA6.6 GF30 black		-		000 08-20-107/93 H340179		
Pos. 9, 10, 11, 12, 13, 15 available as complete seal kits only										
	1	Seal kit		EPDM		000 58-38-007/01 H340575		000 58-38-008/01 H340578		
	1	Seal kit		FPM		000 58-38-007/00 H340577		000 58-38-008/00 H340580		
	1	Seal kit		HNBR		000 58-38-007/06 H340576		000 58-38-008/06 H340579		

Information contained in this document is subject to change without notice and does not represent a commitment on the part of SPX FLOW, Inc.. No part of this document may be reproduced or transmitted in any form or by any means, electronic or mechanical, including photocopying and recording, for any purpose, without the express written permission of SPX FLOW, Inc..

Spare Parts List

Double seat mix proof valve D4 SL 1.5 " - 4"; DN 40 - 100

Date:	16.3.18	30.10.18	11.10.19
Name:	C. Keil	C. Keil	Sze-Si.
Reviewed:			

SPX FLOW

Page 1 of 9

RN 501.047.01

Pos: 34/35 please refer to CU4 manual

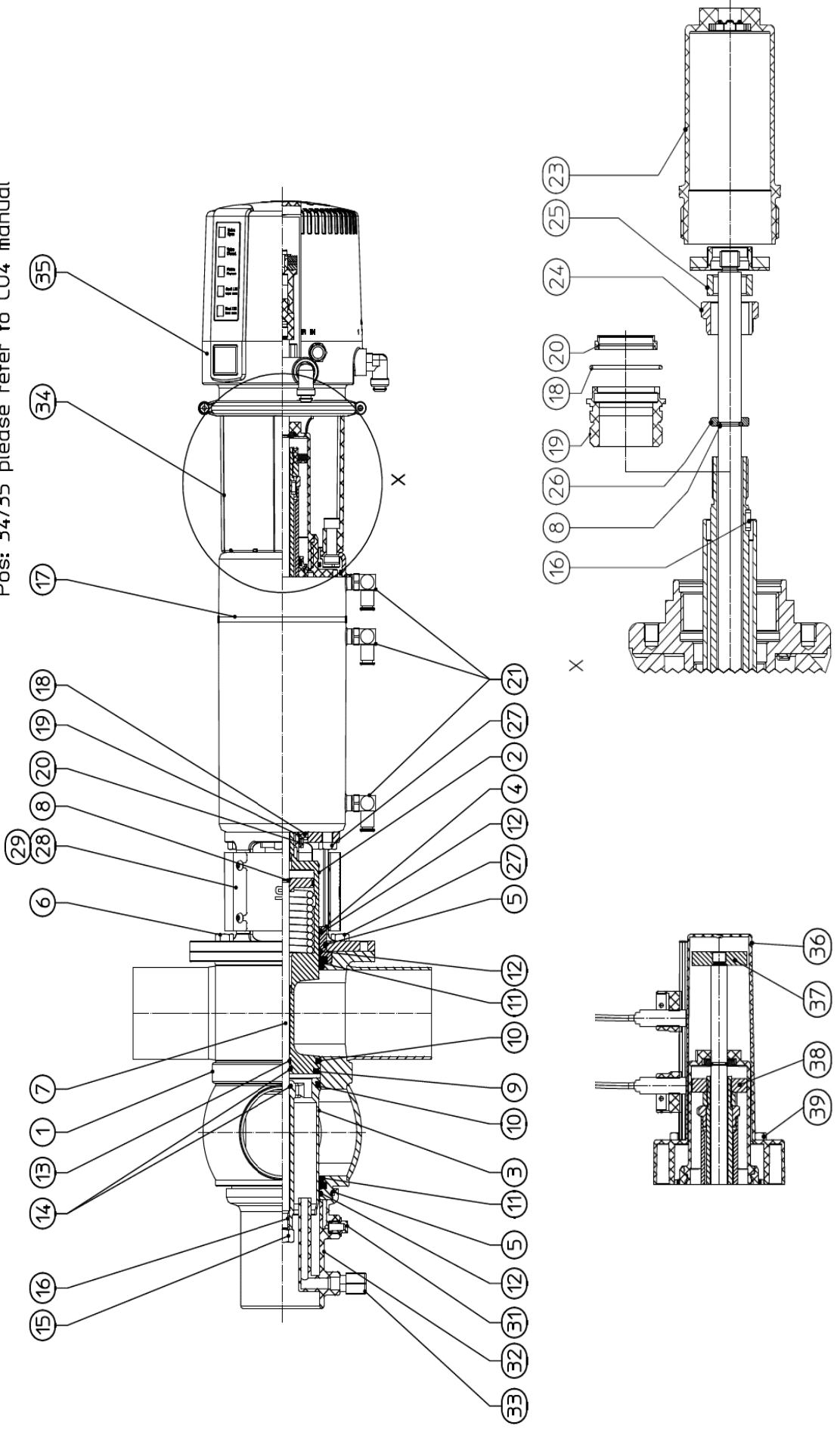

Information contained in this document is subject to change without notice and does not represent a commitment on the part of SPX FLOW, Inc.. No part of this document may be reproduced or transmitted in any form or by any means, electronic or mechanical, including photocopying and recording, for any purpose, without the express written permission of SPX FLOW, Inc..

Spare Parts List

Double seat mix proof valve D4 SL 1.5 "- 4"; DN 40 - 100

Date:	16.3.18	11.10.19	SPX FLOW			
Name:	C. Keil	Size-Si.				
Reviewed:						
Date:			Page	3	of	9
Name:			RN 501.047.01			
Reviewed:						

Pos. Item	Quantity	Description	included in spare parts (pos.)	Material	DN40	1.5"	DN50	2"	DN65	Reference no. Part no.
					Reference no. Part no.	Reference no. Part no.	Reference no. Part no.	Reference no. Part no.		
	2	Seat seal		EPDM			000 58-33-132/93 H168192			
10	2	Seat seal		HNBR			000 58-33-132/33 H171561			
	2	Seat seal		FPM			000 58-33-132/73 H171559			
	2	Shaft seal		EPDM			000 58-33-400/93 H337476			
11	2	Shaft seal		HNBR			000 58-33-400/33 H337478			
	2	Shaft seal		FPM			000 58-33-400/73 H337477			
12	3	Guide ring		Iglidur A500			000 58-01-610/99 H334863			
13	1	Guide band		Acoflon			000 08-39-380/99 H334865			
14	1	Quad ring		EPDM			000 58-01-049/63 H311646			
15	2	Hex. screw M10x1		A2			000 65-50-087/15 H118903			
16	2	Square key		A2			000 29-02-190/17 H335171			
17	1	Actuator	18, 19, 20	1.4301			000 29-02-188/17 H335469		000 29-02-190/17 H334394	000 29-02-189/17 H335468
18	2	O-ring		NBR			000 58-06-113/83 H337897			
19	2	Actuator screw		Iglidur J350			000 16-28-330/93 H334376			
20	2	V-seal		NBR			000 58-01-600/73 H334379			

Information contained in this document is subject to change without notice and does not represent a commitment on the part of SPX FLOW, Inc.. No part of this document may be reproduced or transmitted in any form or by any means, electronic or mechanical, including photocopying and recording, for any purpose, without the express written permission of SPX FLOW, Inc..

Spare Parts List

Double seat mix proof valve D4 SL 1.5" - 4"; DN 40 - 100

		Date:	16.3.18	11.10.19	21.08.20	SPX FLOW						
		Name:	C. Keil	Size-Si.	C. Keil							
		Reviewed:										
		Date:				Page	5 of 9					
		Name:				RN 501.047.01						
		Reviewed:										
Pos.	Item	Quantity	Description	included in spare parts (pos.)	Material	DN40	1.5"	DN50	2"	DN65	Reference no. Part no.	Reference no. Part no.
		1	CU43 D4 DC ø6mm		PA 6.6 GF30 black			000 08-45-381/93 H336955				
		1	CU43 D4 M12 DC ø6mm		PA6.6 GF30 black			000 08-45-571/93 H341343				
		1	CU43 D4 AS-i Ext. Ø6mm		PA 6.6 GF30 black			000 08-45-383/93 H336957				
		1	CU43 D4 M12 AS-i Ext. ø6mm		PA6.6 GF30 black			000 08-45-387/93 H338897				
35		1	CU43 D4 AS-i Std. ø6mm		PA 6.6 GF30 black			000 08-45-385/93 H338152				
		1	CU43 D4 M12 AS-i Std. ø6mm		PA 6.6 GF30 black			000 08-45-391/93 H338899				
		1	CU43plus D4 V1 AS-i Ext. ø6mm		PA6.6 GF30 black			000 08-45-556/93 H338820				
		1	CU43plus D4 V1 M12 AS-i Ext. ø6mm		PA6.6 GF30 black			000 08-45-341/93 H338865				
36		1	Prox. switch holder D4 cmpl.		black			000 16-33-050/93 H336751				
37		1	Operating cam D4 bottom		1.4523 / 444FR			000 08-60-461/99 H334386				
38		1	Operating cam D4 top		1.4523 / 444FR			000 08-60-460/99 H334387				
39		4	Hex. screw M8x40		A2-70			000 65-01-086/15 H336675				
Pos. 9, 10, 11, 12, 14 available as complete seal kits only												
		1	Seal kit		EPDM			000 58-38-005/01 H337884				
		1	Seal kit		FPM			000 58-38-005/00 H337886				
		1	Seal kit		HNBR			000 58-38-005/06 H337885				

Information contained in this document is subject to change without notice and does not represent a commitment on the part of SPX FLOW, Inc.. No part of this document may be reproduced or transmitted in any form or by any means, electronic or mechanical, including photocopying and recording, for any purpose, without the express written permission of SPX FLOW, Inc..

Spare Parts List

Double seat mix proof valve D4 SL 1.5 " - 4"; DN 40 - 100

Pos. Item	Quantity	Description	included in spare parts (pos.)	Material	3"		DN80		DN100		4"		Reference no. Part no.		Reference no. Part no.	
					Reference no. Part no.	Reference no. Part no.	Reference no. Part no.	Reference no. Part no.	Reference no. Part no.	Reference no. Part no.	Reference no. Part no.	Reference no. Part no.				
1	1	Housing	D41 1-6	1.4404	000 16-61-562/47 H337188	000 16-61-537/47 H337183	000 16-61-637/47 H337184	000 16-61-662/47 H337189	000 16-61-666/47 H337194	000 16-61-662/47 H337199	000 16-61-662/47 H337189	000 16-61-666/47 H337199				
	1	Housing	D41 1-7	1.4404	000 16-61-572/47 H337178	000 16-61-547/47 H337173	000 16-61-647/47 H337174	000 16-61-672/47 H337179	000 16-61-641/47 H337194	000 16-62-672/47 H337032	000 16-61-672/47 H337179	000 16-61-666/47 H337199				
	1	Housing	D41 1-8	1.4404	000 16-61-566/47 H337198	000 16-61-541/47 H337193	000 16-61-641/47 H337194	000 16-61-666/47 H337199	000 16-61-641/47 H337194	000 16-62-672/47 H337032	000 16-61-666/47 H337199	000 16-61-666/47 H337199				
	1	Housing	D42	1.4404	000 16-62-572/47 H337031	000 16-62-547/47 H337026	000 16-62-647/47 H337027	000 16-62-672/47 H337032	000 16-62-647/47 H337027	000 16-62-672/47 H337032	000 16-62-672/47 H337032	000 16-62-672/47 H337032				
	1	Housing	D43	1.4404	000 16-63-572/47 H337041	000 16-63-547/47 H337036	000 16-63-647/47 H337037	000 16-63-672/47 H337042	000 16-63-647/47 H337037	000 16-63-672/47 H337042	000 16-63-672/47 H337042	000 16-63-672/47 H337042				
	1	Housing	D44	1.4404	000 16-64-572/47 H335275	000 16-64-547/47 H335278	000 16-64-647/47 H335279	000 16-64-672/47 H335280	000 16-64-547/47 H335279	000 16-64-672/47 H335280	000 16-64-672/47 H335280	000 16-64-672/47 H335280				
	2	Upper valve shaft		1.4404	000 16-25-566/00 H341267	000 16-25-541/00 H341266	000 16-25-541/00 H341266	000 16-25-641/00 H341268	000 16-25-541/00 H341266	000 16-25-641/00 H341268	000 16-25-641/00 H341268	000 16-25-641/00 H341268				
	3	Lower valve shaft		1.4404	000 16-25-564/42 H335392	000 16-25-539/42 H335393	000 16-25-539/42 H335393	000 16-25-639/42 H335394	000 16-25-539/42 H335393	000 16-25-639/42 H335394	000 16-25-639/42 H335394	000 16-25-639/42 H335394				
4	Shaft bearing		1.4404	000 16-28-300/12 H334381	000 16-28-300/12 H334381	000 16-28-301/12 H335713	000 16-28-301/12 H335713	000 16-28-301/12 H335713	000 16-28-301/12 H335713	000 16-28-301/12 H335713	000 16-28-301/12 H335713					
5	O-ring		EPDM	000 58-06-295/64 H77039	000 58-06-295/64 H77039	000 58-06-490/63 H77061	000 58-06-490/63 H77061	000 58-06-490/63 H77061	000 58-06-490/63 H77061	000 58-06-490/63 H77061	000 58-06-490/63 H77061					
6	Yoke		1.4301	000 16-40-200/12 H334383	000 16-40-200/12 H334383	000 16-40-209/12 H335994	000 16-40-209/12 H335994	000 16-40-209/12 H335994	000 16-40-209/12 H335994	000 16-40-209/12 H335994	000 16-40-209/12 H335994					
7	Guide rod		1.4404	000 16-25-562/00 H341296	000 16-25-537/00 H341295	000 16-25-537/00 H341295	000 16-25-637/00 H341297	000 16-25-537/00 H341295	000 16-25-637/00 H341297	000 16-25-637/00 H341297	000 16-25-637/00 H341297					
8	Retainer ring		1.4310	000 08-39-998/93 H327602	000 08-39-998/93 H327602	000 08-39-997/93 H327985	000 08-39-997/93 H327985	000 08-39-997/93 H327985	000 08-39-997/93 H327985	000 08-39-997/93 H327985	000 08-39-997/93 H327985					
9	Middle seal		HNBR	000 58-33-998/33 H332652	000 58-33-998/33 H332652	000 58-33-997/33 H332649	000 58-33-997/33 H332649	000 58-33-997/33 H332649	000 58-33-997/33 H332649	000 58-33-997/33 H332649	000 58-33-997/33 H332649					
1	Middle seal		FPM	000 58-33-998/71 H332653	000 58-33-998/71 H332653	000 58-33-997/71 H332648	000 58-33-997/71 H332648	000 58-33-997/71 H332648	000 58-33-997/71 H332648	000 58-33-997/71 H332648	000 58-33-997/71 H332648					

Information contained in this document is subject to change without notice and does not represent a commitment on the part of SPX FLOW, Inc.. No part of this document may be reproduced or transmitted in any form or by any means, electronic or mechanical, including photocopying and recording, for any purpose, without the express written permission of SPX FLOW, Inc..

Spare Parts List

Double seat mix proof valve D4 SL 1.5 "- 4"; DN 40 - 100

Date:	16.3.18	11.10.19
Name:	C. Keil	Size-Si.
Reviewed:		

Date:		
Name:		
Reviewed:		

SPX FLOW

Pos. Item	Quantity	Description	included in spare parts (pos.)	Material	3"		DN80		4"		Reference no. Part no.
					Reference no. Part no.	Reference no. Part no.	Reference no. Part no.	Reference no. Part no.			
10	2	Seat seal		EPDM	000 58-33-132/93 H168192	000 58-33-133/93 H168153					
	2	Seat seal		HNBR	000 58-33-132/33 H171561	000 58-33-133/33 H171565					
	2	Seat seal		FPM	000 58-33-132/73 H171559	000 58-33-133/73 H171563					
11	2	Shaft seal		EPDM	000 58-33-400/93 H337476	000 58-33-405/93 H337668					
	2	Shaft seal		HNBR	000 58-33-400/33 H337478	000 58-33-405/33 H337670					
	2	Shaft seal		FPM	000 58-33-400/73 H337477	000 58-33-405/73 H337669					
12	3	Guide ring		Iglidur A500	000 58-01-610/99 H334863	000 58-01-612/99 H335702					
13	1	Guide band		Acoflon		000 08-39-380/99 H334865					
14	1	Quad ring	12,37x2,62	EPDM		000 58-01-049/63 H311646					
						000 65-50-087/15 H118903					
15	2	Hex. screw M10x1		A2		000 67-40-010/12 H335171					
16	2	Square key		A2		000 29-02-206/17 H335862					
17	1	Actuator	18, 19, 20	1.4301	000 29-02-190/17 H334394						
					000 58-06-113/83 H337897						
18	2	O-ring		NBR		000 16-28-330/93 H334376					
19	2	Actuator screw		Iglidur J350	000 58-01-600/73 H334379						
20	2	V-seal		NBR							

Information contained in this document is subject to change without notice and does not represent a commitment on the part of SPX FLOW, Inc. No part of this document may be reproduced or transmitted in any form or by any means, electronic or mechanical, including photocopying and recording, for any purpose, without the express written permission of SPX FLOW, Inc..

Spare Parts List

Double seat mix proof valve D4 SL 1.5" - 4"; DN 40 - 100

		Date: 16.3.18 11.10.19 21.08.20		SPX FLOW						
		Name: C.Keil C.Keil								
		Reviewed:								
		Date:		Page 9 of 9						
		Name:		RN 501.047.01						
		Reviewed:								
Pos.	Quantity	Description	included in spare parts (pos.)	Material	3" Reference no. Part no.	DN80 Reference no. Part no.	DN100 Reference no. Part no.	4" Reference no. Part no.	Reference no. Part no.	Reference no. Part no.
	1	CU43 D4 DC ø6mm		PA 6.6 GF30 black	000 08-45-381/93 H336955					
	1	CU43 D4 M12 DC ø6mm		PA6.6 GF30 black	000 08-45-571/93 H341343					
	1	CU43 D4 AS-i Ext. Ø6mm		PA 6.6 GF30 black	000 08-45-383/93 H336957					
	1	CU43 D4 M12 AS-i Ext. ø6mm		PA6.6 GF30 black	000 08-45-387/93 H338897					
35	1	CU43 D4 AS-i Std. ø6mm		PA 6.6 GF30 black	000 08-45-385/93 H338152					
	1	CU43 D4 M12 AS-i Std. ø6mm		PA 6.6 GF30 black	000 08-45-391/93 H338899					
	1	CU43plus D4 V1 AS-i Ext. ø6mm		PA6.6 GF30 black	000 08-45-556/93 H338820					
	1	CU43plus D4 V1 M12 AS-i Ext. ø6mm		PA6.6 GF30 black	000 08-45-341/93 H338865					
36	1	Prox. switch holder D4 cmpl.		PA 6.6 GF30 black	000 16-33-050/93 H336751					
37	1	Operating cam D4 bottom		1.4523 / 444FR	000 08-60-461/99 H334386					
38	1	Operating cam D4 top		1.4523 / 444FR	000 08-60-460/99 H334387					
39	4	Hex. screw M8x40		A2-70	000 65-01-086/15 H336675					
Pos. 9, 10, 11, 12, 14 available as complete seal kits only										
	1	Seal kit		EPDM	000 58-38-005/01 H337884	000 58-38-006/01 H337887				
	1	Seal kit		FPM	000 58-38-005/00 H337886	000 58-38-006/00 H337889				
	1	Seal kit		HNBR	000 58-38-005/06 H337885	000 58-38-006/06 H337888				

Information contained in this document is subject to change without notice and does not represent a commitment on the part of SPX FLOW, Inc.. No part of this document may be reproduced or transmitted in any form or by any means, electronic or mechanical, including photocopying and recording, for any purpose, without the express written permission of SPX FLOW, Inc..

Spare Parts list

**Double seat mix proof valve
D4 SL - 125-150-6"**

SPX FLOW

Date:	11.10.19	10.06.20
Name:	Sze-Si.	C.Keil
Reviewed:		

Page 1 of 5
RN 501.047.03

Date:		
Name:		
Reviewed:		

Date:		
Name:		
Reviewed:		

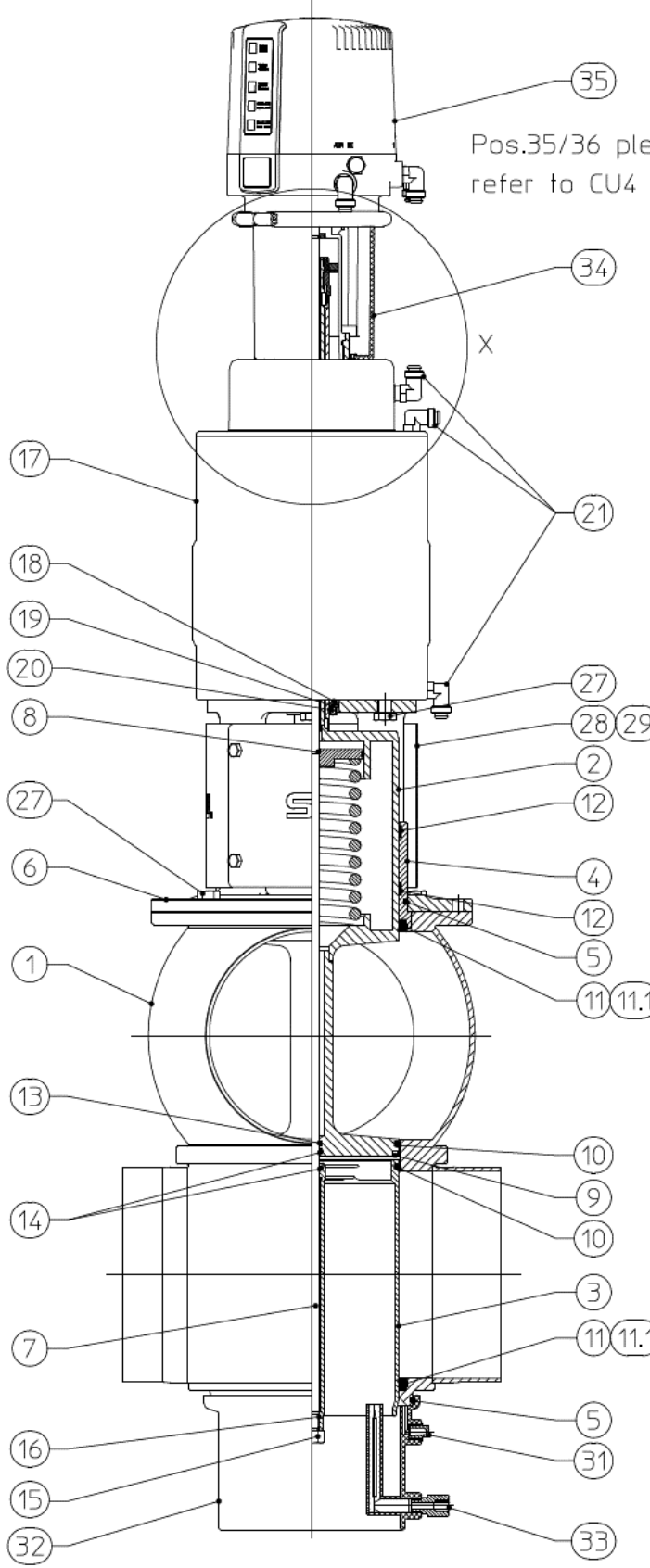

Pos.35/36 please refer to CU4 manual

Detail X

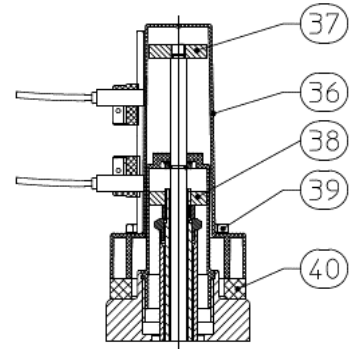
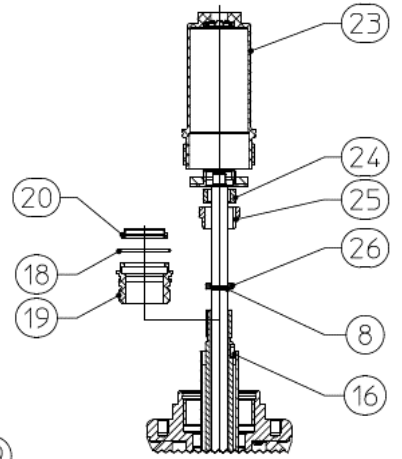

Information contained in this document is subject to change without notice and does not represent a commitment on the part of SPX FLOW, Inc.. No part of this document may be reproduced or transmitted in any form or by any means, electronic or mechanical, including photocopying and recording, for any purpose, without the express written permission of SPX FLOW, Inc..

Spare Parts list

Double seat mix proof valve D4 SL - 125-150-6"

		Date: 11.10.19 Name: Size-Si. Reviewed:			Date: _____ Name: _____ Reviewed: _____			Page 2 of 5 RN 501.047.03		
Pos.	Qty.	Description	Material	DN125 Reference no. Part no.	DN150 Reference no. Part no.	6" Reference no. Part no.				
	1	Housing D41 / 1-6	1.4404	000 16-61-687/47 H340122	000 16-61-737/47 H340135	000 16-61-762/47 H340141				
	1	Housing D41 / 1-7	1.4404	000 16-61-697/47 H340123	000 16-61-747/47 H340136	000 16-61-772/47 H340142				
	1	Housing D41 / 1-8	1.4404	000 16-61-691/47 H340124	000 16-61-741/47 H340137	000 16-61-766/47 H340143				
1	1	Housing D42	1.4404	000 16-62-697/47 H340121	000 16-62-747/47 H340134	000 16-62-772/47 H340140				
	1	Housing D43	1.4404	000 16-63-697/47 H340120	000 16-63-747/47 H340133	000 16-63-772/47 H340139				
	1	Housing D44	1.4404	000 16-64-697/47 H340119	000 16-64-747/47 H340132	000 16-64-772/47 H340138				
2	1	Upper valve shaft	1.4404	000 16-25-694/00 H341269	000 16-25-694/00 H341270					
3	1	Lower valve shaft	1.4404	000 16-25-689/42 H340230	000 16-25-520/42 H340311					
4	1	Shaft bearing	1.4404	000 16-28-302/12 H340243	000 16-28-303/12 H340322					
5	2	O-ring	EPDM	000 58-06-555/63 H77074	000 58-06-655/63 H77081					
6	1	Yoke	1.4301	000 16-40-202/12 H340244	000 16-40-204/12 H340323					
7	1	Guide rod	1.4404	000 16-25-687/00 H341298	000 16-25-545/00 H341299					
8	2	Retainer ring	1.4310	08-39-083/13 H14883						
	1	Middle seal	EPDM	000 58-33-996/93 H340247	000 58-33-995/93 H340325					
9	1	Middle seal	HNBR	000 58-33-996/33 H340248	000 58-33-995/33 H340326					
	1	Middle seal	FPM	000 58-33-996/73 H340294	000 58-33-995/73 H340327					

Information contained in this document is subject to change without notice and does not represent a commitment on the part of SPX FLOW, Inc.. No part of this document may be reproduced or transmitted in any form or by any means, electronic or mechanical, including photocopying and recording, for any purpose, without the express written permission of SPX FLOW, Inc..

Spare Parts list

**Double seat mix proof valve
D4 SL - 125-150-6"**

		Date:	11.10.19												
		Name:	Size-Si.												
		Reviewed:													
		Date:													
		Name:													
		Reviewed:													
												Page	3	of	5
												RN 501.047.03			
pos.	item	Quantity	Description	included in spare parts (pos.)	Material	125 Reference no. Part no.	150 Reference no. Part no.	6" Reference no. Part no.							
		2	Seat seal		EPDM	000 58-33-135/93 H173940	000 58-33-134/93 H173739								
10		2	Seat seal		HNBR	000 58-33-135/33 H173939	000 58-33-134/33 H173738								
		2	Seat seal		FPM	000 58-33-135/73 H340246	000 58-33-134/73 H338070								
		2	Shaft seal		EPDM	000 58-33-693/93 H77611	000 58-33-743/93 H77628								
11		2	Shaft seal		HNBR	000 58-33-693/33 H170178	000 58-33-743/33 H170177								
		2	Shaft seal		FPM	000 58-33-693/73 H77610	000 58-33-743/73 H77627								
11.1		2	PTFE Shaft seal		PTFE	000 58-33-156/23 H340295	000 58-33-157/23 H340328								
12		2	Guide ring		Igildur A500	000 58-01-614/99 H340198	000 58-01-613/99 H340182								
13		1	Guide band		Acoflon	000 08-39-380/99 H334865									
14		2	Quad ring 12,37x 2,62		EPDM	000 58-01-049/63 H311646									
15		2	Hex. Screw M10x1		A2	000 65-50-087/15 H118903									
16		2	Square key DIN6885 - A - 3x3x10		A2	000 29-02-190/17 H335171									
17		1	Actuator	18, 19, 20	1.4301	000 29-02-208/17 H340197	000 29-02-207/17 H340181								
18		2	O-ring 30 x 2,5		NBR	000 58-06-113/83 H337897									
19		2	Actuator screw		Igildur J350	000 16-28-330/93 H334376									
20		2	V-seal		NBR	000 58-01-600/73 H334379									

Information contained in this document is subject to change without notice and does not represent a commitment on the part of SPX FLOW, Inc.. No part of this document may be reproduced or transmitted in any form or by any means, electronic or mechanical, including photocopying and recording, for any purpose, without the express written permission of SPX FLOW, Inc..

Spare Parts list

Double seat mix proof valve D4 SL - 125-150-6"

pos. item		Quantity		Description		included in spare parts (pos.)		Material		125		150		6"		Reference no. Part no.		Reference no. Part no.	
										Reference no. Part no.		Reference no. Part no.		Reference no. Part no.					
								hard nickel-plated		000 08-60-750/93 H208825									
		1		Stop screw				Grivory		000 16-28-340/39 H334382									
		1		Lock washer D4				1.4301		000 67-03-030/12 H335172									
		1		Safety nut D3				1.4301		000 65-50-137/15 H147640									
		1		Thrust ring				1.4057		000 08-48-106/12 H123151									
		8		Hex. screw M10 x 20				A2		000 65-01-134/13 H340472									
		1		Yoke cover D4		29		1.4301		000 16-40-226/00 H341313		000 16-40-227/00 H341314							
		4		Savetix head screw M6 x 8 washer M6 as set				1.4301		000 65-06-011/12 H340632									
		1		Venting plug G-1/8"				PE-Hard		000 08-74-014/93 H16507									
		1		Spray connection DE3				PP		000 09-40-117/93 H178450		000 09-40-118/93 H200320							
		1		G-union 10/8-G1/4" with supp. Sleeve cpl.				1.4571		000 16-38-200/42 H329696									
		1		CU4 D4 adapter cmpl.				PA6.6 GF30 black		000 08-46-646/93 H337098									
		1		CU4plus D4 V1 adapter cmpl.				PA6.6 GF30 black		000 08-46-666/93 H336441									

Information contained in this document is subject to change without notice and does not represent a commitment on the part of SPX FLOW, Inc.. No part of this document may be reproduced or transmitted in any form or by any means, electronic or mechanical, including photocopying and recording, for any purpose, without the express written permission of SPX FLOW, Inc..

Spare Parts list

Double seat mix proof valve D4 SL - 125-150-6"

SPX FLOW

pos. item		Description		included in spare parts (pos.)		Material		125		150		6"		Reference no. Part no.		
								Reference no. Part no.	Reference no. Part no.	Reference no. Part no.	Reference no. Part no.					
1	CU43 D4 DC ø6mm					PA6.6 GF30 black		000 08-45-381/93 H336955								
1	CU43 D4 M12 DC ø6mm					PA6.6 GF30 black		000 08-45-571/93 H341343								
1	CU43 D4 AS-i Ext. ø6mm					PA6.6 GF30 black		000 08-45-383/93 H336957								
1	CU43 D4 M12 AS-i Ext. ø6mm					PA6.6 GF30 black		000 08-45-387/93 H338897								
1	CU43plus D4 V1 AS-i Ext. ø6mm					PA6.6 GF30 black		000 08-45-556/93 H338820								
1	CU43plus D4 V1 M12 AS-i Ext. ø6mm					PA6.6 GF30 black		000 08-45-341/93 H338865								
1	Prox. switch holder D4 compl.					PA6.6 GF30 black		000 16-33-050/93 H336751								
1	Operating cam D4 bottom					1.4523 / 444FR		000 08-60-461/99 H334386								
1	Operating cam D4 top					1.4523 / 444FR		000 08-60-460/99 H334387								
4	Hex. Screw					A2-70		000 65-01-086/15 H336675		000 65-01-087/15 H340751						
1	Spacer					PA6.6 GF30 black		-		000 08-20-107/93 H340179						
Pos. 9, 10, 11, 12, 13, 15 available as complete seal kits only																
1	Seal kit					EPDM		000 58-38-007/01 H340575		000 58-38-008/01 H340578						
1	Seal kit					FPM		000 58-38-007/00 H340577		000 58-38-008/00 H340580						
1	Seal kit					HNBR		000 58-38-007/06 H340576		000 58-38-008/06 H340579						

APV D4 / D4 SL

双座防混阀

SPXFLOW

SPX FLOW

Design Center

Gottlieb-Daimler-Straße 13
D-59439 Holzwickede, Germany
P: (+49) (0) 2301-9186-0
F: (+49) (0) 2301-9186-300

SPX FLOW, Inc.

Production

611 Sugar Creek Road
Delavan, WI 53115, USA
P: (+1) 262 728 1900 or (800) 252 5200
F: (+1) 262 728 4904 or (800) 252 5012
E: wcb@spxflow.com

SPX FLOW

Production

Stanisława Jana Rolbieskiego 2
PL- Bydgoszcz 85-862, Poland
P: (+48) 52 566 76 00
F: (+48) 52 525 99 09

SPX FLOW 保留技术变更和重大更改的权利，恕不另行通知。

本文件中提及的设计特性、材料和尺寸仅供参考。未经进一步书面确认，概不保证信息的准确性。有关产品的可用性，请联系您当地经销商。
如需了解更多信息，请访问我们的网站: www.spxflow.com

发布日期: 09/2020 - 原版使用说明书翻译版

COPYRIGHT ©2020 SPX FLOW, Inc.